

Customer Information Sheet

IF IN DOUBT - ASK

©

NOT TO SCALE

THIRD ANGLE PROJECTION

ALL DIMENSIONS IN mm

SPECIFICATIONS:

MATERIAL:

HOUSING = GLASS-FILLED PPS,
UL94V-0, BLACK

CONTACT = PHOSPHOR BRONZE

JACKSCREW = STAINLESS STEEL

FINISH (CONTACTS):

NICKEL ALL OVER CONTACTS

05 = ALL OVER GOLD

22 = GOLD ON CONTACT AREA,
90/10 TIN/LEAD ON TAILS

42 = GOLD ON CONTACT AREA,
100% TIN ON TAILS

PACKING: TUBE

FOR COMPLETE SPECIFICATION, SEE COMPONENT
SPECIFICATION CO05XX (LATEST ISSUE)

PART No.	WEIGHT (g)
M80-50204XX	0.43
M80-50206XX	0.50
M80-50208XX	0.57
M80-50210XX	0.64
M80-50212XX	0.71
M80-50214XX	0.78
M80-50216XX	0.85
M80-50218XX	0.92
M80-50220XX	0.98
M80-50222XX	1.05
M80-50224XX	1.12
M80-50226XX	1.19
M80-50228XX	1.26
M80-50230XX	1.33
M80-50232XX	1.40
M80-50234XX	1.47
M80-50236XX	1.54
M80-50238XX	1.60
M80-50240XX	1.67
M80-50242XX	1.74
M80-50246XX	1.88
M80-50248XX	1.95
M80-50250XX	2.02

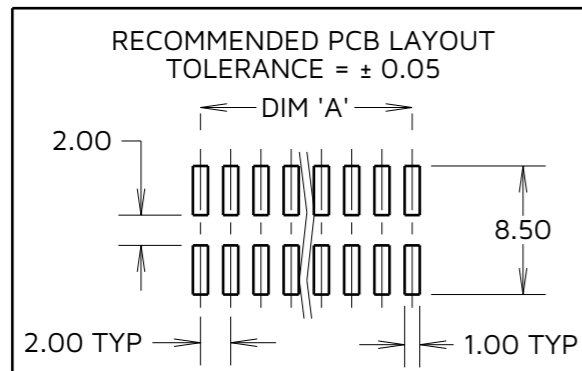
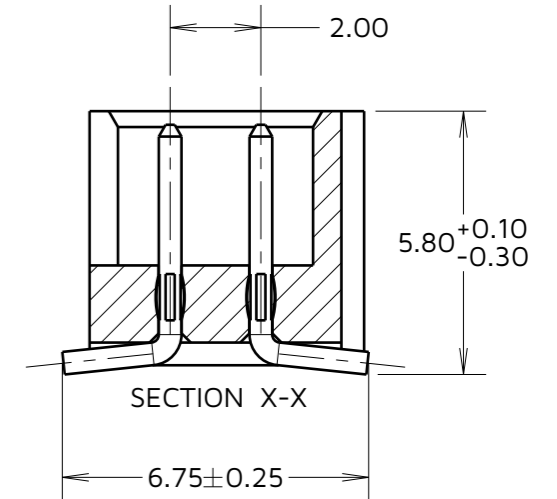
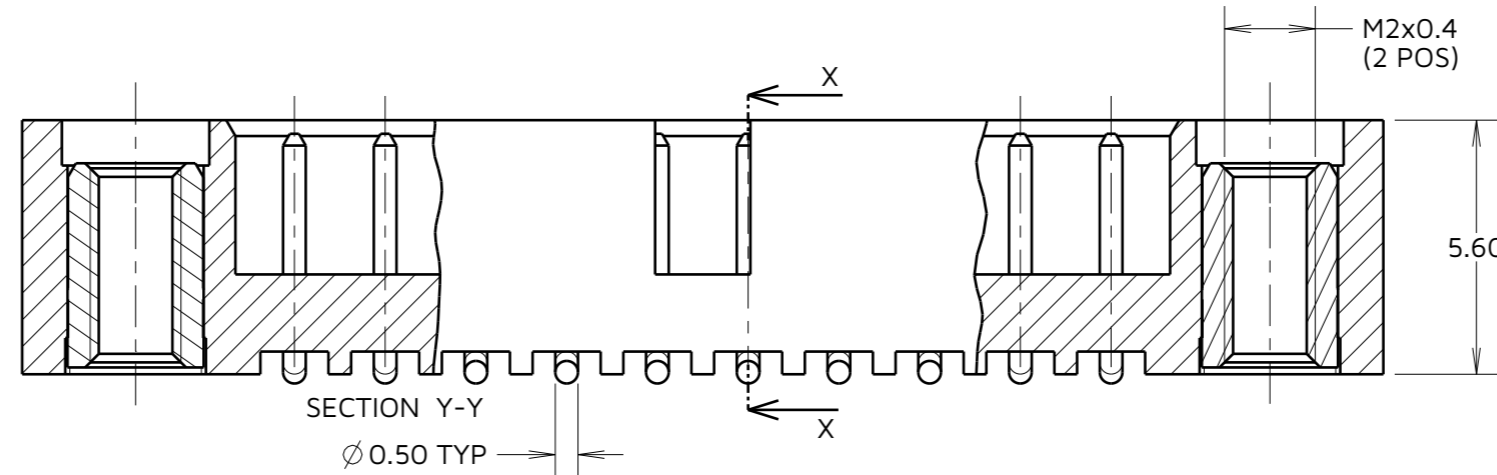
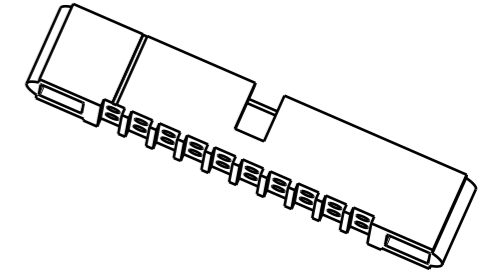
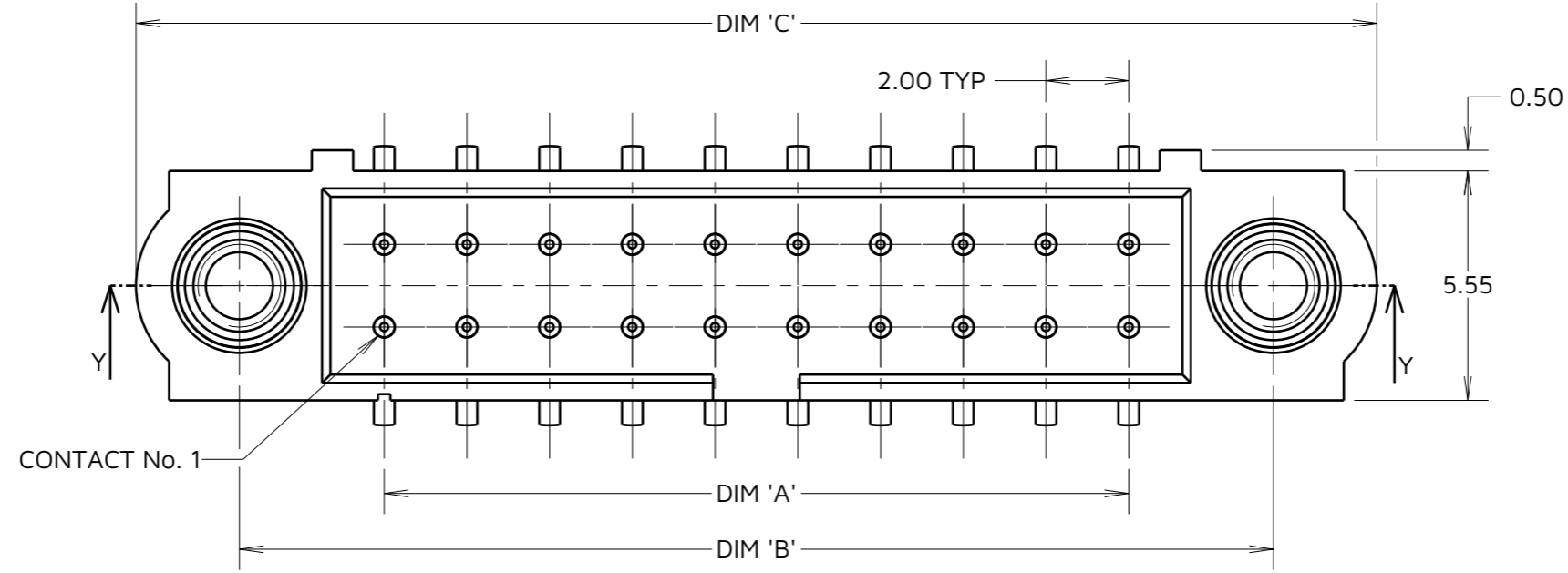

DIMENSION	CALCULATION
DIM 'A'	TOTAL No. OF CONTACTS - 2.00
DIM 'B'	TOTAL No. OF CONTACTS + 5.00
DIM 'C'	TOTAL No. OF CONTACTS + 10.0

EXAMPLE: CONNECTOR WITH 20 CONTACTS
M80-50220XX
DIM 'A' = 18.00mm, DIM 'B' = 25.00mm, DIM 'C' = 30.00mm

ORDER CODE:
M80-502XXXX

TOTAL No. OF CONTACTS
04 TO 50
(EVEN NUMBERS ONLY)

FINISH CODE _____

05 - ALL OVER GOLD
22 - SELECTIVE GOLD + TIN/LEAD
42 - SELECTIVE GOLD + 100% TIN

MJ	7	05.12.24	35293
NAME	ISS.	DATE	CN/CO
APPROVED:	M. JELLEY		
CHECKED:	R. ALEXANDER		
DRAWN:	B. M. KENT		

NOTES:

1. M80-50220XX IS SHOWN FOR ILLUSTRATION PURPOSES, SEE ORDER CODE FOR VARIANTS

HARWIN

www.harwin.com

TOLERANCES
X. = ±1mm
X.X = ±0.50mm
X.XX = ±0.20mm
X.XXX = ±0.01mm
ANGLES = ±5°
UNLESS STATED

THIS DRAWING AND ANY INFORMATION OR DESCRIPTIVE MATTER SET OUT HEREON ARE CONFIDENTIAL AND COPYRIGHT PROPERTY OF THE HARWIN GROUP AND MUST NOT BE DISCLOSED, LOANED, COPIED OR USED FOR MANUFACTURING, SENDERING OR FOR ANY OTHER PURPOSE WITHOUT THEIR WRITTEN PERMISSION.

MATERIAL & FINISH:
SEE ABOVE

TITLE: JACKSCREW DATAMATE
DIL VERTICAL SMT
MALE ASSEMBLY

DRAWING NUMBER:
M80-502XXXX

SHT
2 OF 2