

Customer Information Sheet

Specifications:

Material:

Housing = Glass-filled PPS, UL94V-0, Black

Contact = Copper Alloy

Jackscrew & Retainer = Stainless Steel

Finish:

Contact = Gold

Packing:

Bag

For Complete Specification, See Component Specification C005XX (Latest Issue)

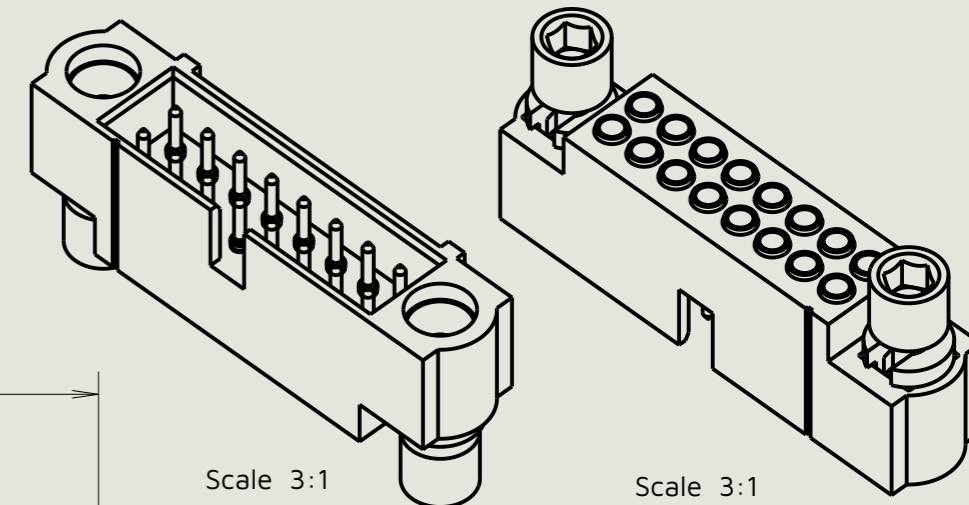
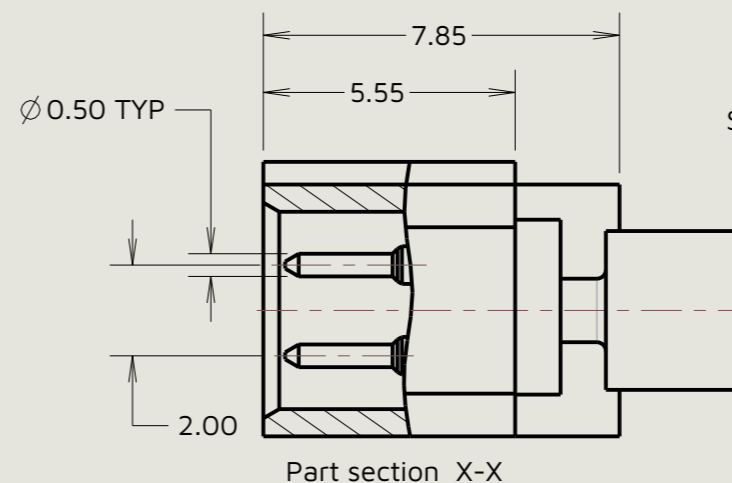
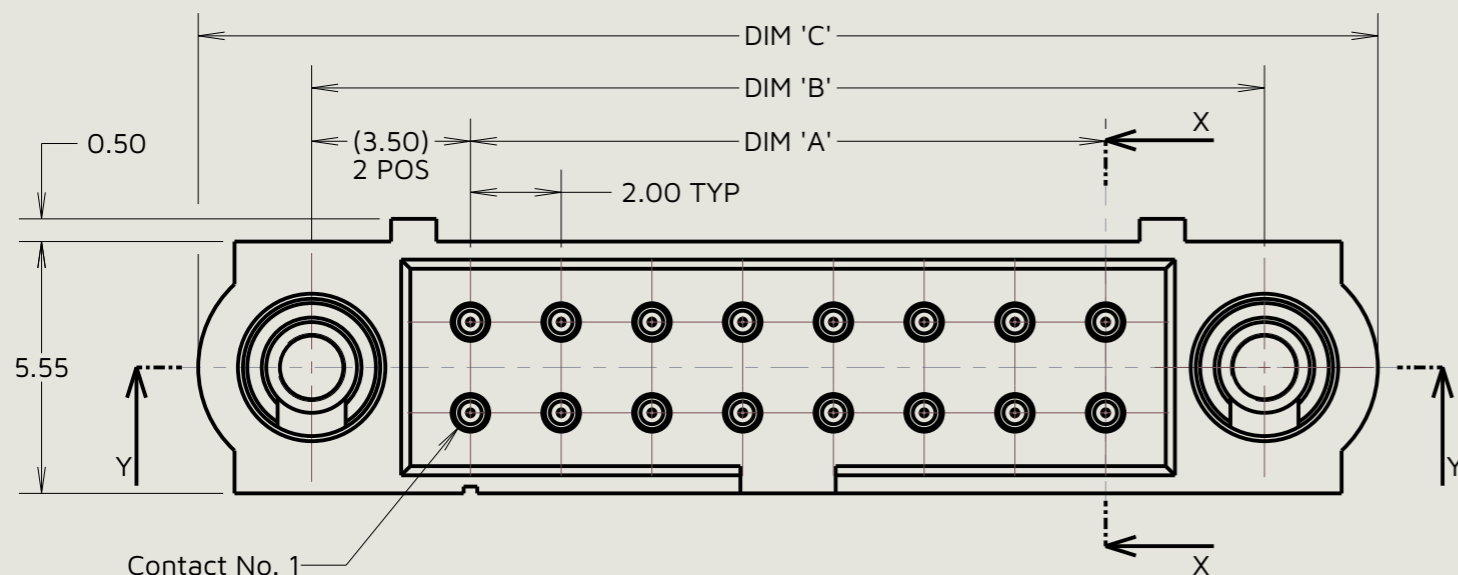

Contact No. 1

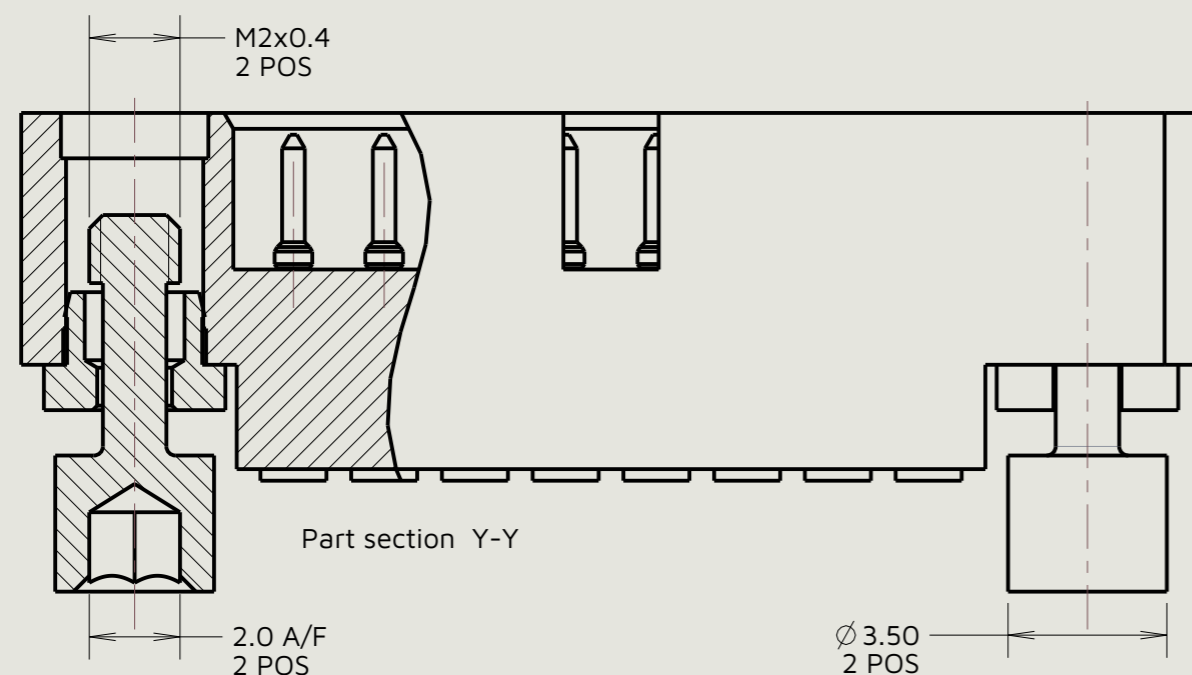

Table 1: Dimension variants

Part No.	DIM 'A'	DIM 'B'	DIM 'C'
M80-5820405	2.00	9.00	14.0
M80-5820605	4.00	11.00	16.0
M80-5820805	6.00	13.00	18.0
M80-5821005	8.00	15.00	20.0
M80-5821205	10.00	17.00	22.0
M80-5821605	12.00	19.00	24.0
M80-5821405	14.00	21.00	26.0
M80-5821805	16.00	23.00	28.0
M80-5822005	18.00	25.00	30.0
M80-5822205	20.00	27.00	32.0
M80-5822405	22.00	29.00	34.0
M80-5822605	24.00	31.00	36.0
M80-5822805	26.00	33.00	38.0
M80-5823005	28.00	35.00	40.0
M80-5823205	30.00	37.00	42.0
M80-5823405	32.00	39.00	44.0
M80-5823605	34.00	41.00	46.0
M80-5823805	36.00	43.00	48.0
M80-5824005	38.00	45.00	50.0
M80-5824205	40.00	47.00	52.0
M80-5824405	42.00	49.00	54.0
M80-5824605	44.00	51.00	56.0
M80-5824805	46.00	53.00	58.0
M80-5825005	48.00	55.00	60.0

Order code:
M80-582XX05
Total No. of contacts _____
04 to 50
(Even numbers only)

MJ	6	28.01.26	37709
Initials	Rev.	Date	CO
RA	A	10.07.07	-----

- Notes:**
- Connectors are supplied with contacts loose.
 - For extra contacts, use part number M80-1940005.
 - Compatible wire size = 22AWG, with MAX insulation ϕ 1.10mm. Strip wire by 2.00mm
 - See Component Specification C049XX (latest issue) to see recommendations on wire specification and type.
 - Recommended hand crimp tool = M22520/2-01 with positioner T5747. Refer to tooling instruction sheet IS-01 for complete crimping instructions.
 - Contact insertion and extraction tool = Z80-280. Refer to tooling instruction sheet IS-25 for assembly instructions.
 - Part M80-5821605 used for illustration only, see order code for variants.

 www.harwin.com	This drawing and any information or descriptive matter set out hereon are confidential and copyright property of the Harwin group and must not be disclosed, loaned, copied or used for manufacturing, tendering or for any other purpose without their written permission.	TOLERANCES X. = ± 0.50 mm X.X = ± 0.30 mm X.XX = ± 0.10 mm X.XXX = ± 0.01 mm Angles = $\pm 5^\circ$ Unless stated	Third angle projection 	MATERIAL: See Specification	Title: Datamate J-Tek Male Plug DIL Crimp (22AWG) with 'Reverse Fix' Jackscrew Drawing number: M80-582XX05	SHT 2 OF 2
		Sheet scale: 6:1 Do not scale Sheet size: A3	FINISH: See Specification			