

# Customer Information Sheet

## Coax Crimp Contacts Only

Specifications:  
 Material:  
 Housing: Glass Filled PPS, UL94V-0, Black  
 Coax Contact:  
 Body, Sleeve, Inner Contact, End Plug = Copper Alloy  
 Latching Collar = Beryllium Copper  
 Insulator = PTFE  
 Board Mount Jackscrew, Screw = Stainless Steel  
 Finish:  
 Coax Contact:  
 Body, Sleeve, Inner Contact, End Plug = Gold  
 Latching Collar = Nickel  
 Packing:  
 Bag  
 For Complete Specification See Component Specification C005XX (Latest Issue)

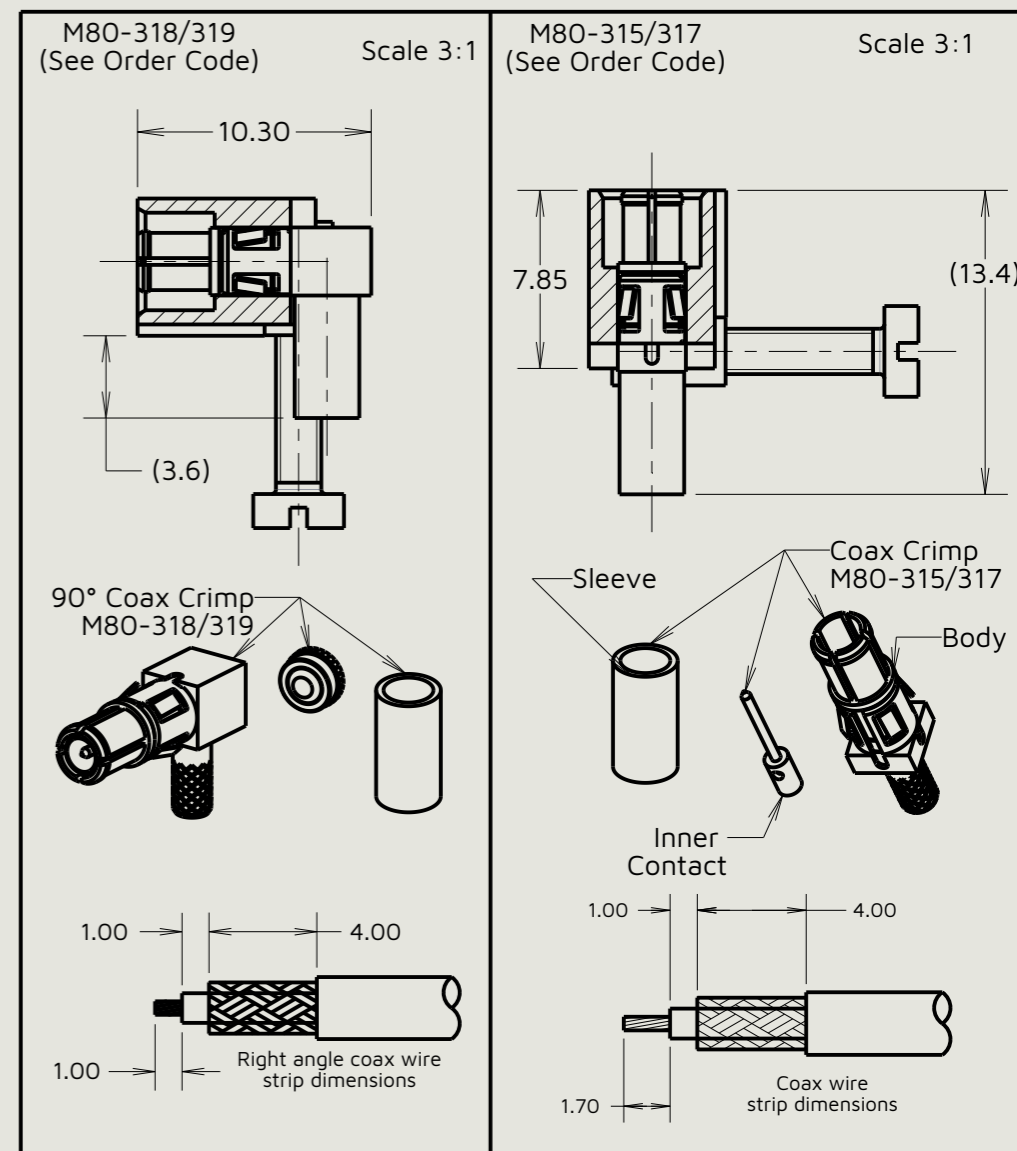
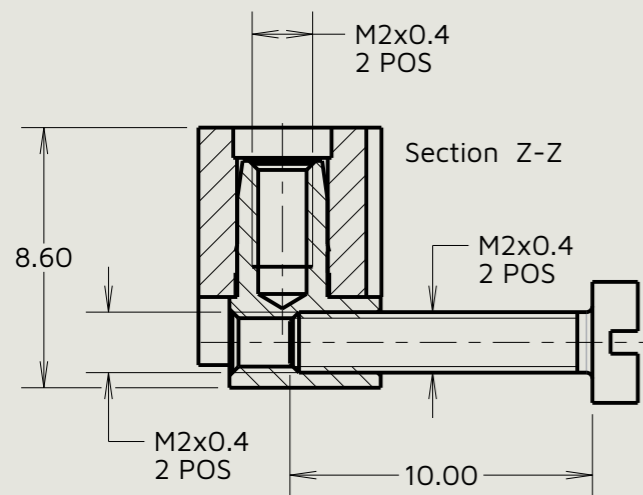
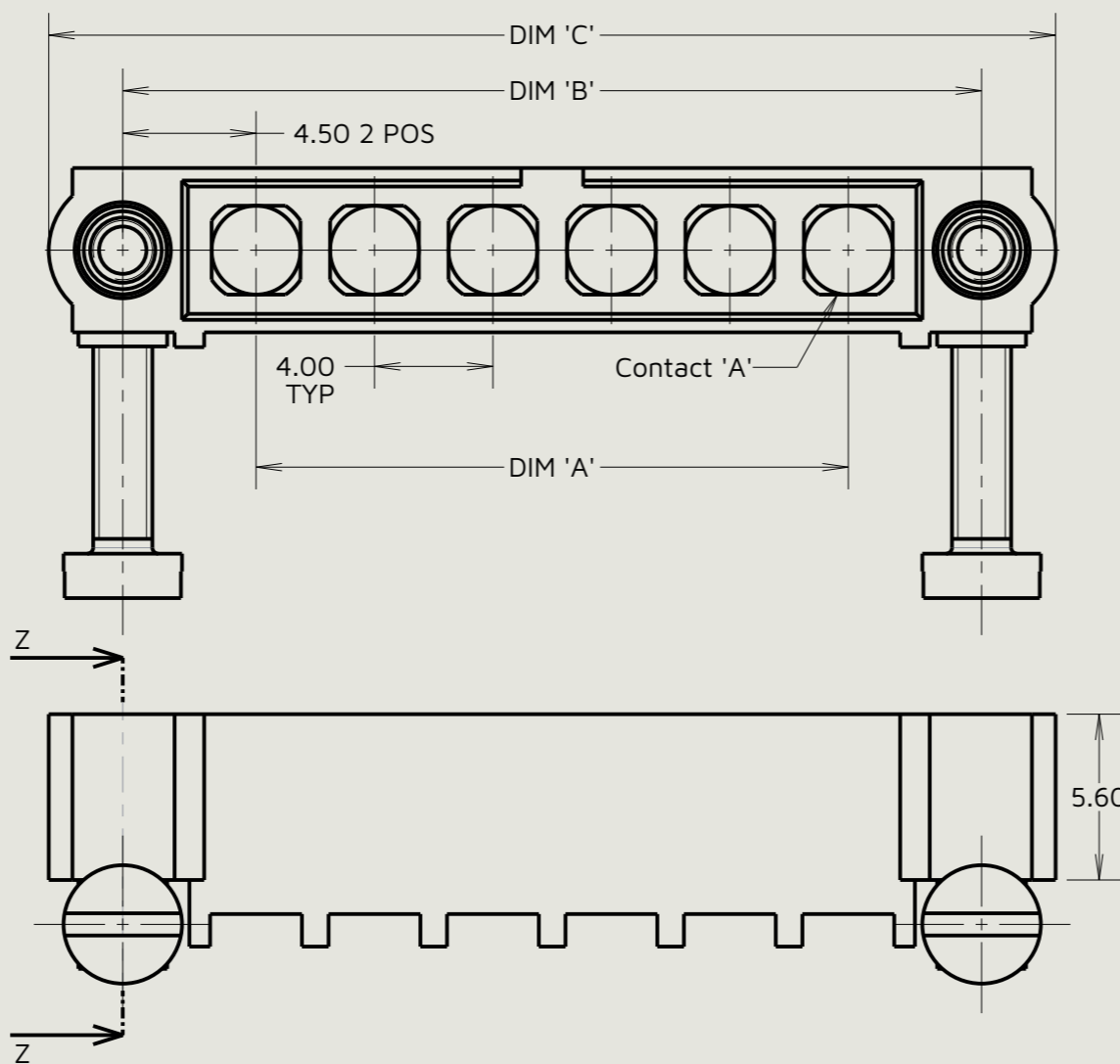

Dimension	Calculation
DIM 'A'	4 x No. Of Contacts - 4.00
DIM 'B'	4 x No. Of Contacts + 5.00
DIM 'C'	4 x No. Of Contacts + 10.00

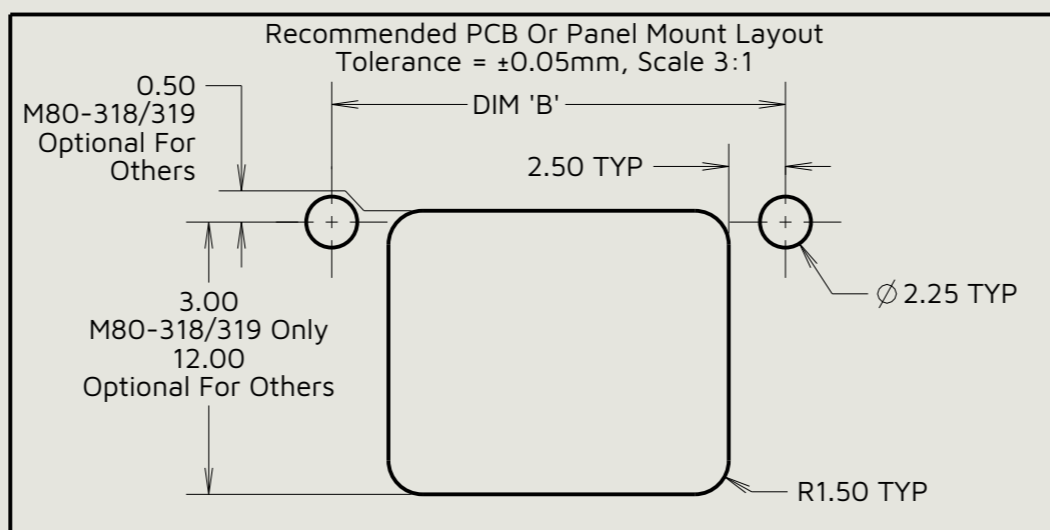

Order Code:  
**M80-5000000MN-XX-XXX-00-000**  
 Total No. Of Contacts: \_\_\_\_\_  
 02 To 12  
 Special Contacts: \_\_\_\_\_  
 315 = Coax Contact 2.00mm Crimp M80-315  
 317 = Coax Contact 2.70mm Crimp M80-317  
 318 = Coax Contact 2.00mm Right Angle Crimp M80-318  
 319 = Coax Contact 2.70mm Right Angle Crimp M80-319

- Notes:
- Connectors are supplied with contacts loose.
  - Coax contact is supplied as a kit of parts: Body, Main Insulator, Inner Contact and Latching Collar are pre-assembled. Sleeve Insulated End Plug assembly are separate.
  - For extra coax contacts, use part numbers M80-315/317/318/319.
  - Coax contact extraction tool = Z80-290.
  - Recommended hand crimp tool for inner coax contact = Z80-292 with positioner Z80-291. Recommended hand crimp tool and die set for sleeve = Z80-293.
  - Instruction sheets are available.



This drawing and any information or descriptive matter set out hereon are confidential and copyright property of the Harwin group and must not be disclosed, loaned, copied or used for manufacturing, tendering or for any other purpose without their written permission.

TOLERANCES  
 X. =  $\pm 0.50$ mm  
 X.X =  $\pm 0.30$ mm  
 X.XX =  $\pm 0.10$ mm  
 X.XXX =  $\pm 0.01$ mm  
 Angles =  $\pm 5^\circ$   
 Unless stated

Third angle projection  
  
 Sheet scale: 4:1  
 Do not scale  
 Sheet size: A3

MATERIAL:  
 See Specification  
 FINISH:  
 See Specification

Title:  
**Datamate Mix Tek Male Plug Board Mount Jackscrews PC Tail Connector**  
 Drawing number:  
**M80-5000000MN-XX-XXX-00-000**  
 SHT 4 OF 6

MJ	5	28.01.26	37709
Initials	Rev.	Date	CO
SB	1	24.05.11	11275

# Customer Information Sheet

## Power Crimp & Solder Contacts Only

Specifications:  
 Material:  
 Housing :Glass Filled PPS, UL94V-0, Black  
 Power Contact:  
 Body, Sleeve, Inner Contact, End Plug = Copper Alloy  
 Latching Collar = Beryllium Copper  
 Insulator = PTFE  
 Board Mount Jackscrew, Screw: Stainless Steel  
 Finish:  
 Power Contact:  
 Body, Sleeve, Inner Contact, End Plug = Gold  
 Latching Collar = Nickel  
 Packing:  
 Bag  
 For Complete Specification See Component Specification C005XX (Latest Issue)

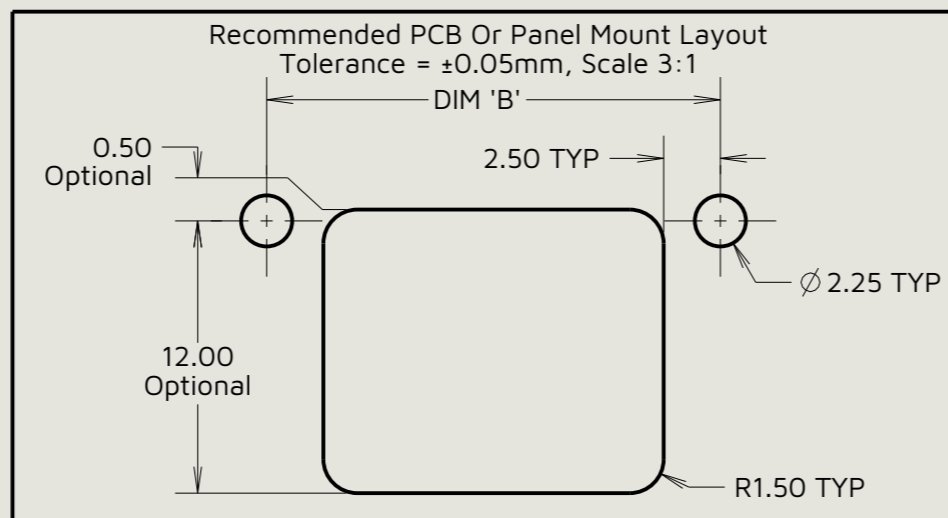
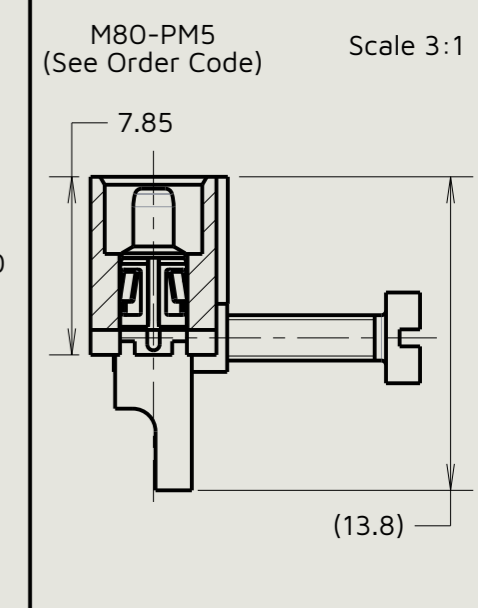
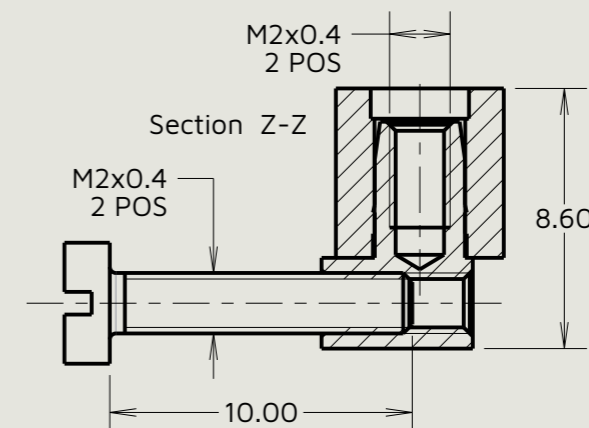
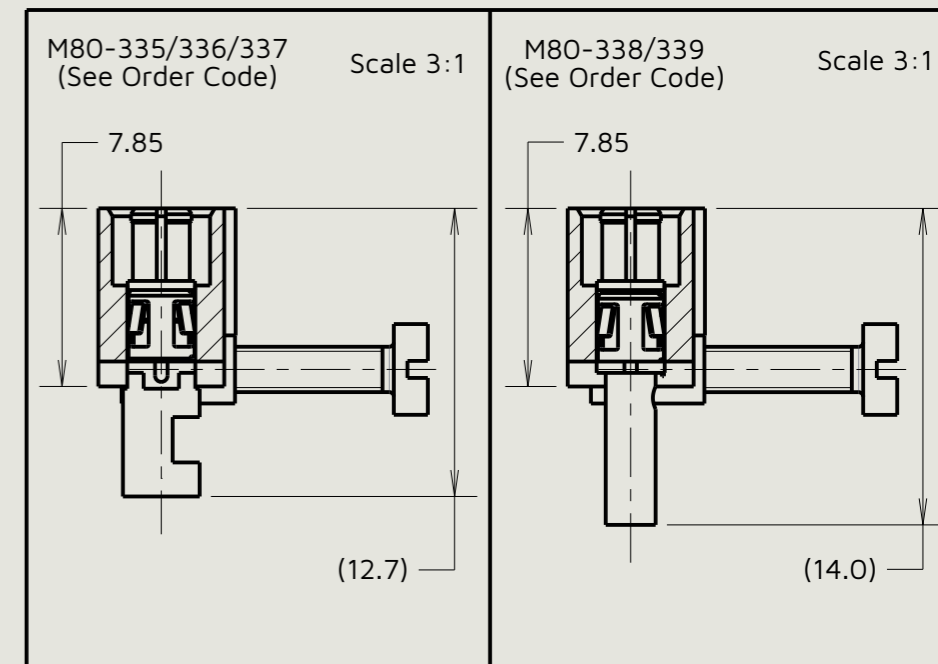
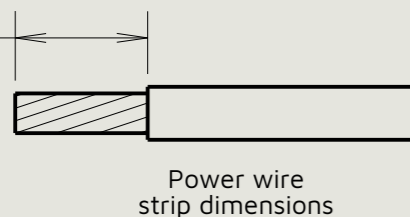
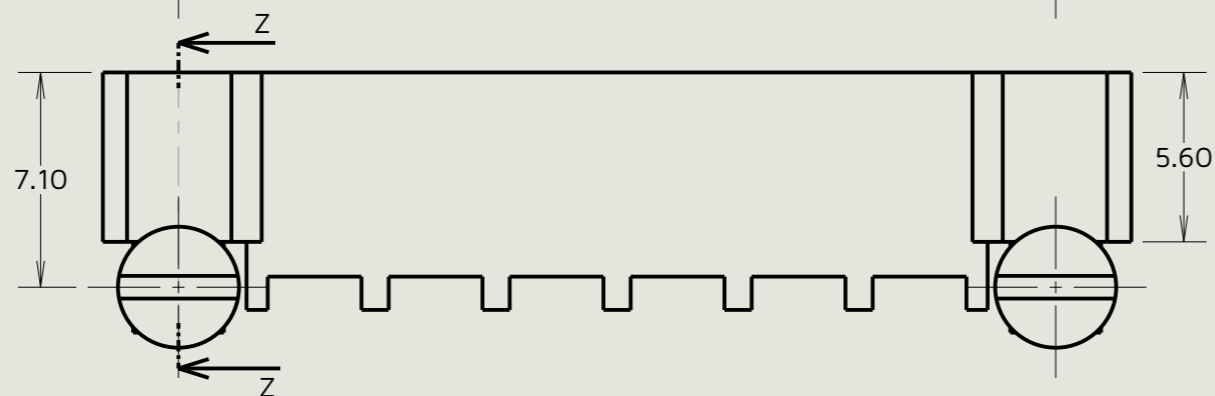
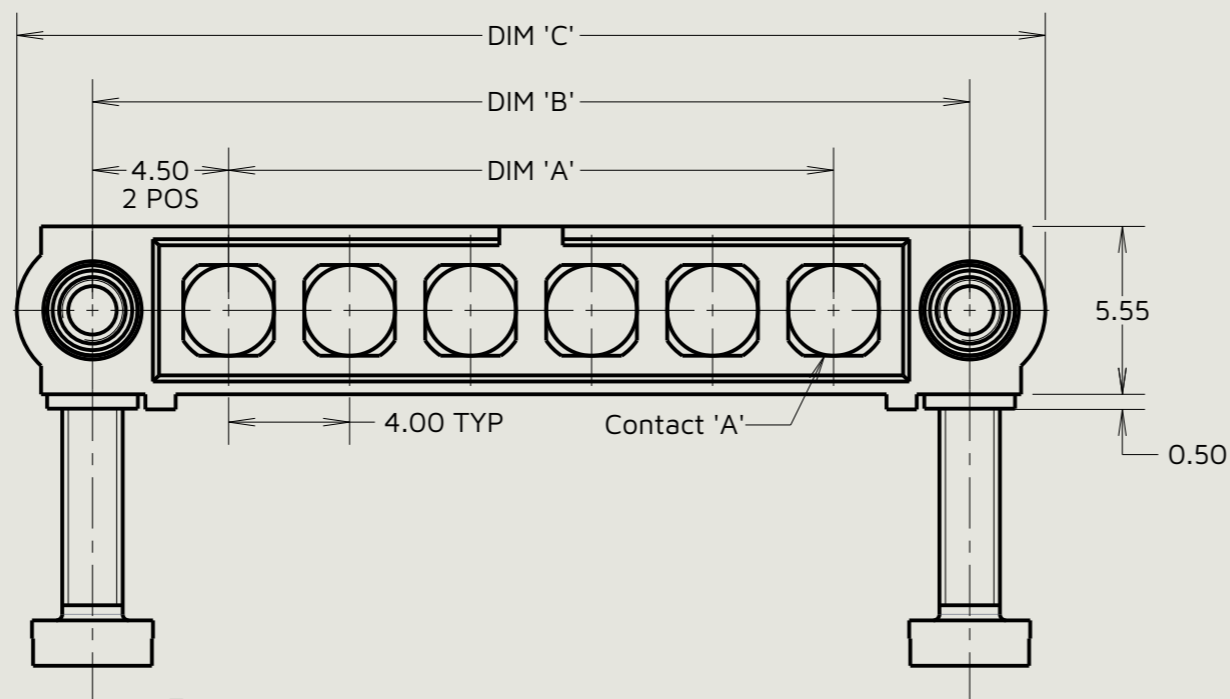

Order Code:  
**M80-5000000MN-XX-XXX-00-000**  
 Total No. Of Contacts: \_\_\_\_\_  
 02 To 12  
 Special Contacts: \_\_\_\_\_  
 335 = Power Contact 12AWG Solder M80-335  
 336 = Power Contact 14AWG Solder M80-336  
 337 = Power Contact 16AWG Solder M80-337  
 338 = Power Contact 18AWG Solder/Crimp M80-338  
 339 = Power Contact 20AWG Solder/Crimp M80-339  
 PM5 = Power Contact 10AWG Solder M80-PM5

Dimension	Calculation
DIM 'A'	4 x No. Of Contacts - 4.00
DIM 'B'	4 x No. Of Contacts + 5.00
DIM 'C'	4 x No. Of Contacts + 10.0

MJ	5	28.01.26	37709
Initials	Rev.	Date	CO
SB	1	24.05.11	11275

Notes:  
 1. Connectors are supplied with contacts loose.  
 2. For extra power contacts use part numbers M80-335/336/337/338/339/PM5.  
 3. Power contact extraction tool = Z80-290.  
 4. Recommended hand crimp tool for contacts M80-338/339 = Z80-294 and positioner Z80-295.  
 5. Instruction sheets are available.  
 6. M80-50000000MN-06-XXX-00-000 is shown for illustration purposes only, see order code for variants.

	This drawing and any information or descriptive matter set out hereon are confidential and copyright property of the Harwin group and must not be disclosed, loaned, copied or used for manufacturing, tendering or for any other purpose without their written permission.	TOLERANCES X. = ±0.50mm X.X = ±0.30mm X.XX = ±0.10mm X.XXX = ±0.01mm Angles = ±5° Unless stated	Third angle projection 	MATERIAL: See Specification	Title: Datamate Mix Tek Male Plug Board Mount Jackscrews PC Tail Connector
		Sheet scale: 4:1 Do not scale Sheet size: A3	FINISH: See Specification	Drawing number: <b>M80-5000000MN-XX-XXX-00-000</b>	SHT 5 OF 6

# Customer Information Sheet

Recommended PCB Layout For Power SMT:  
M80-33A Tolerance = ±0.05mm, Scale 3:1

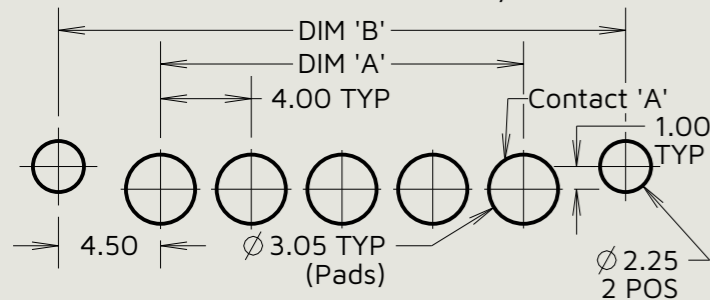

Recommended PCB Layout For Power Contacts:  
M80-333/334 Tolerance = ±0.05mm, Scale 3:1

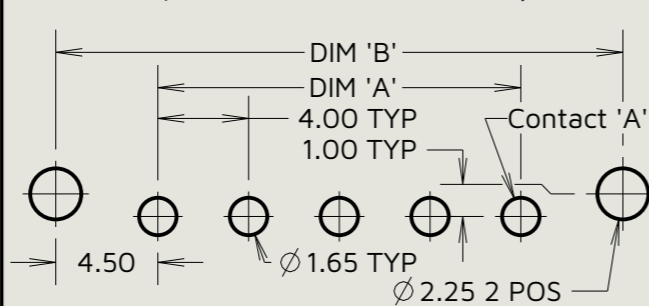

Recommended PCB Layout For Power Contacts:  
M80-PM3/PM4 Tolerance = ±0.05mm, Scale 3:1

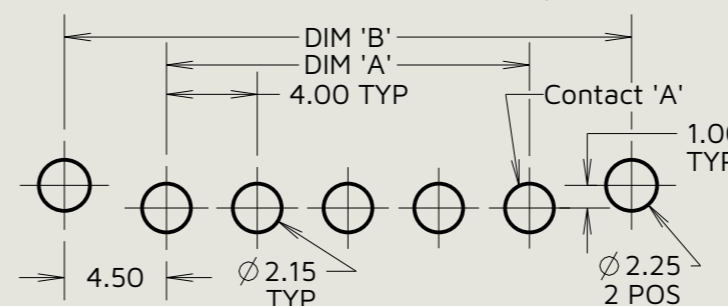

Recommended PCB Layout For Coax Contacts:  
M80-313/314 Tolerance = ±0.05mm, Scale 3:1

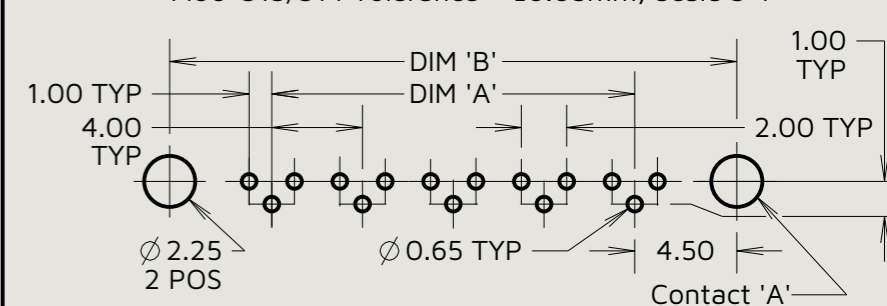

Specifications:  
Material:  
Housing: Glass Filled PPS, UL94V-0, Black  
Power Contact: Copper Alloy  
Coax Contact:  
Body = Copper Alloy  
Inner Contact = Copper Alloy  
Insulator = PTFE  
Board Mount Jackscrews = Stainless Steel  
Finish:  
Power Contact: Gold  
Coax Contact: Body, Inner Contact = Gold  
Packing:  
Tube  
For Complete Specification See Component Specification C005XX (Latest Issue)

## Horizontal PC Tail & SMT Contacts Only

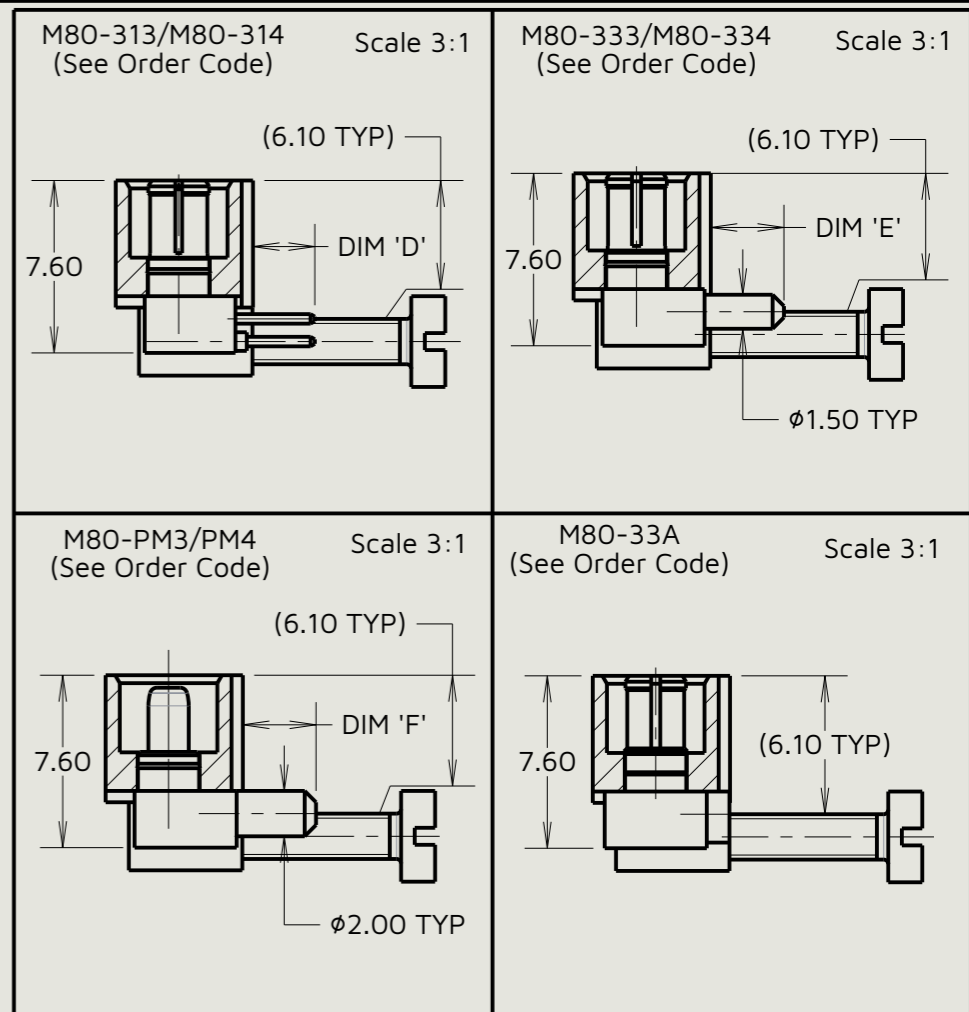
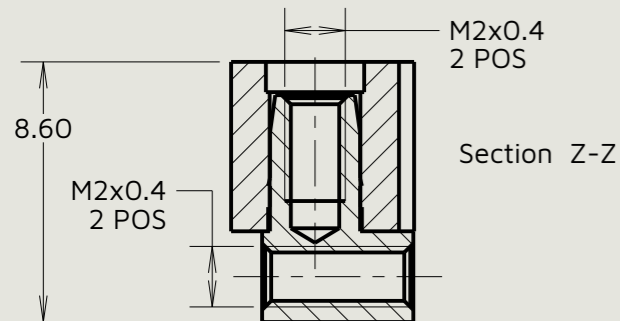
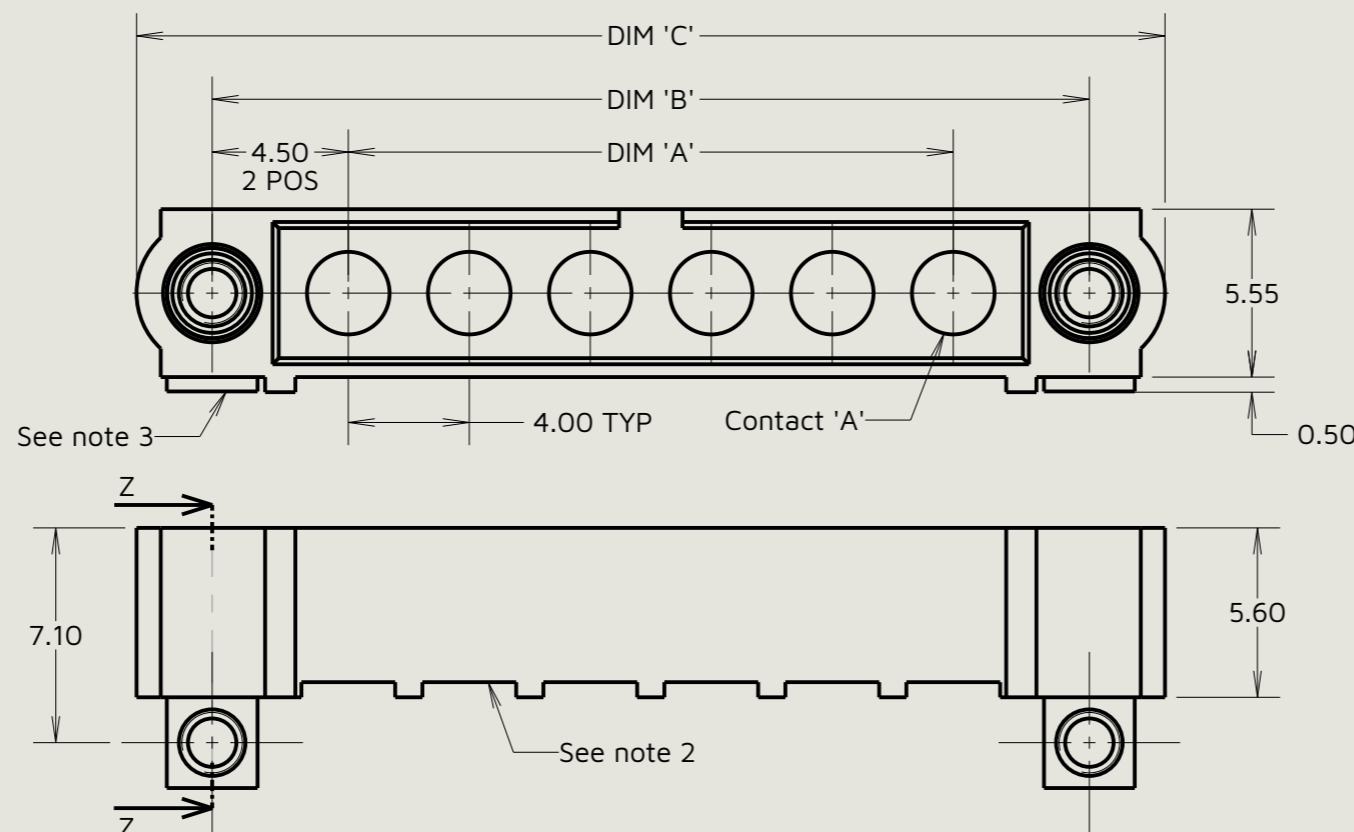

Dimension	Calculation
DIM 'A'	4 x No. Of Contacts - 4.00
DIM 'B'	4 x No. Of Contacts + 5.00
DIM 'C'	4 x No. Of Contacts + 10.0
DIM 'D'	M80-313 = 2.7mm, M80-314 = 4.2mm
DIM 'E'	M80-333 = 3.2mm, M80-334 = 4.7mm
DIM 'F'	M80-PM3 = 3.2mm, M80-PM4 = 4.7mm

Order Code:  
**M80-5000000MN-XX-XXX-00-000**  
Total No. Of Contacts: \_\_\_\_\_  
02 To 12  
Special Contacts:  
313 = Coax Contact 3.0mm PC Tail M80-313  
314 = Coax Contact 4.5mm PC Tail M80-314  
333 = 20A Power Contact 3.5mm Right Angle PC Tail M80-333  
334 = 20A Power Contact 5.0mm Right Angle PC Tail M80-334  
PM3 = 40A Power Contact 3.5mm Right Angle PC Tail M80-PM3  
PM4 = 40A Power Contact 5.0mm Right Angle PC Tail M80-PM4  
33A = Power Contact Right Angle SMT M80-33A

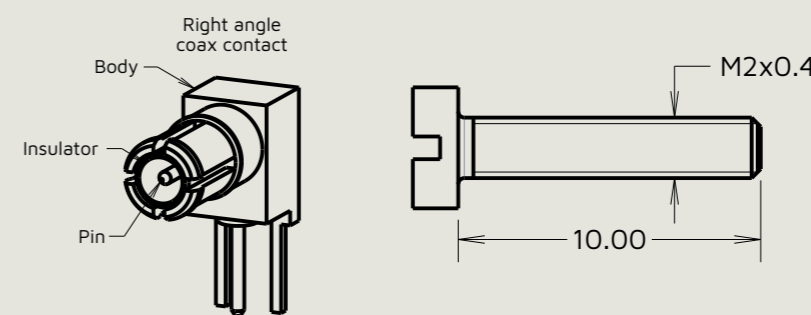

MJ	5	28.01.26	37709
Initials	Rev.	Date	CO
SB	1	24.05.11	11275

Notes:  
1. M80-5000000MN-06-XXX-00-000 is shown for illustration purposes only, see order code for details.  
2. Contacts are hidden for visualisation purposes only.  
3. Jackscrews are hidden for visualisation purposes only.

**HARWIN**  
www.harwin.com

This drawing and any information or descriptive matter set out hereon are confidential and copyright property of the Harwin group and must not be disclosed, loaned, copied or used for manufacturing, tendering or for any other purpose without their written permission.

TOLERANCES  
X. = ±0.50mm  
X.X = ±0.30mm  
X.XX = ±0.10mm  
X.XXX = ±0.01mm  
Angles = ±5°  
Unless stated

Third angle projection  
  
Sheet scale: 4:1  
Do not scale  
Sheet size: A3

MATERIAL:  
See Specification  
FINISH:  
See Specification

Title:  
Datamate Mix Tek Male Plug Board Mount Jackscrews PC Tail Connector  
Drawing number:  
**M80-5000000MN-XX-XXX-00-000**