

# Customer Information Sheet

**Specifications:**

- Material:**  
 Housing: Glass Filled PPS, UL94V-0, Black  
 Coax Contact:  
 Body, Sleeve, Inner Contact, End Plug = Copper Alloy  
 Latching Collar = Beryllium Copper  
 Insulator = PTFE  
 Board Mount Jackscrew, Nut = Stainless Steel
- Finish:**  
 Coax Contact:  
 Body, Sleeve, Inner Contact, End Plug = Gold  
 Latching Collar = Nickel
- Packing:**  
 Bag  
 For Complete Specification See Component Specification C005XX (Latest Issue)

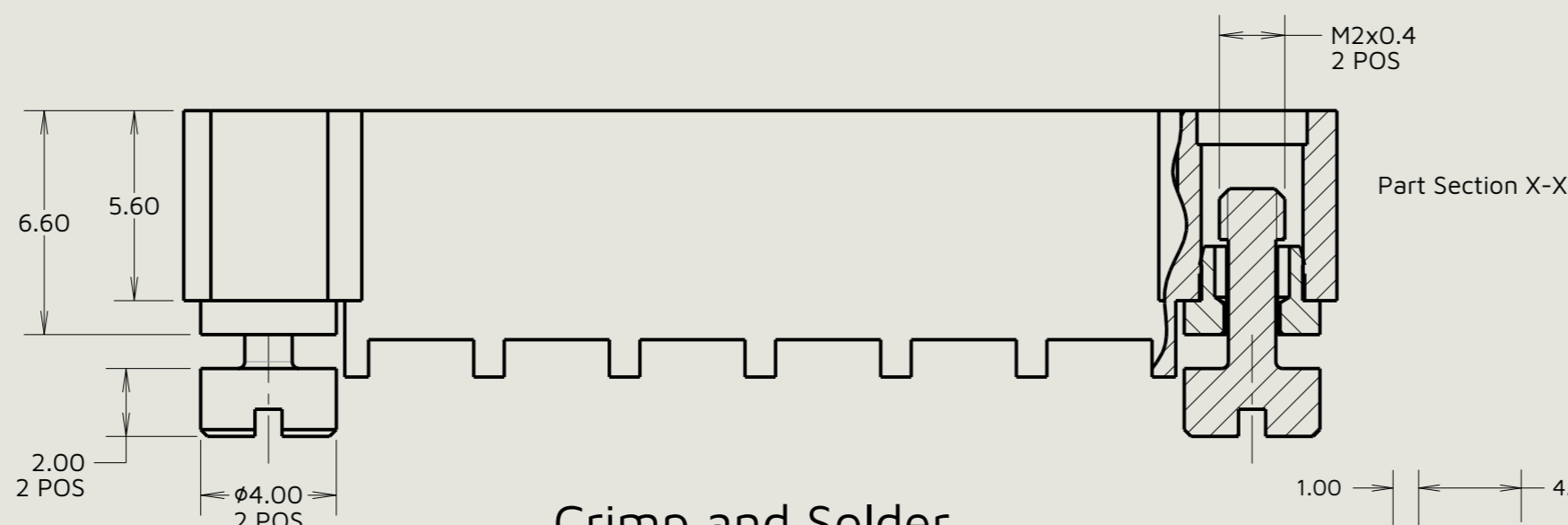
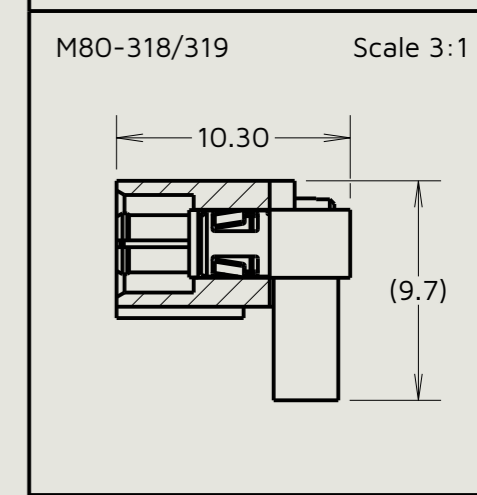
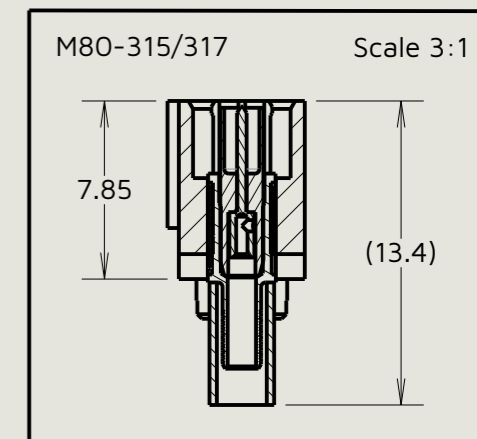
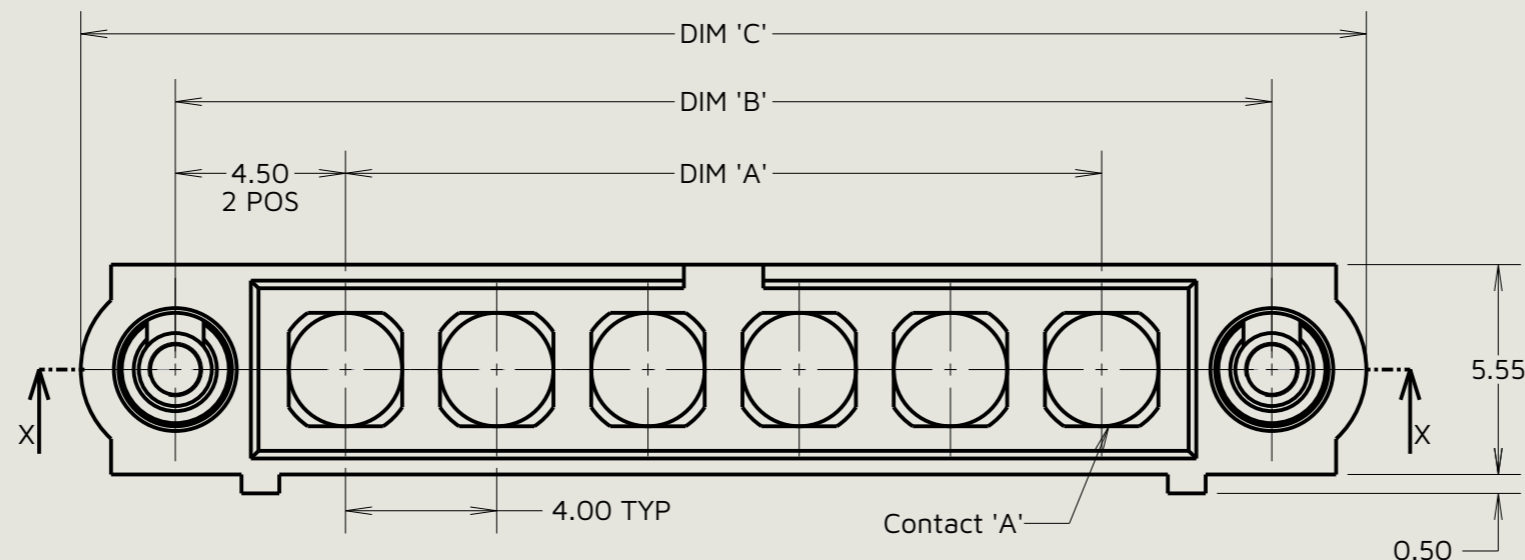

## Crimp and Solder Contacts Only

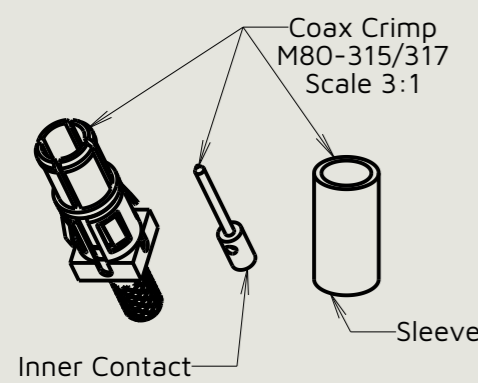
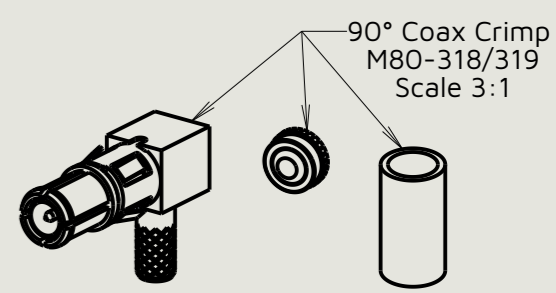
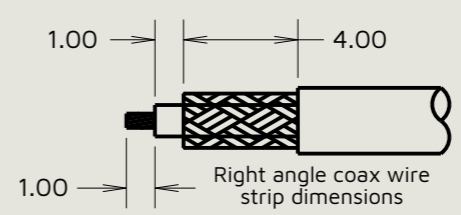
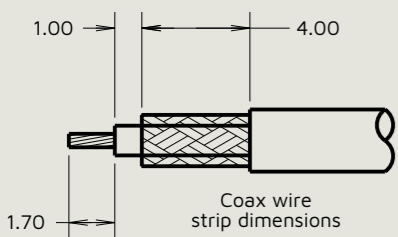

Table 1: Dimension Variants

Dimension	Calculation
DIM 'A'	4 x No. Of Contacts - 4.00
DIM 'B'	4 x No. Of Contacts + 5.00
DIM 'C'	4 x No. Of Contacts + 10.0

Order Code:  
**M80-5000000MA-XX-XXX-00-000**

Total No. Of Contacts:  
 02 To 12

Special Contacts:  
 315 = Coax Contact 2.00mm Crimp M80-315  
 317 = Coax Contact 2.70mm Crimp M80-317  
 318 = Coax Contact 2.70mm Right-Angle Crimp M80-318  
 319 = Coax Contact 2.70mm Right-Angle Crimp M80-319

MJ	5	28.01.26	37709
Initials	Rev.	Date	CO
SB	1	19.08.11	11275

- Notes:**
- Connectors are supplied with contacts loose.
  - Coax contact is supplied as a kit of parts: Body, Main Insulator, Inner Contact and Latching Collar are pre-assembled. Sleeve and insulated End Plug assembly are separate.
  - For extra coax contacts, use part numbers M80-315/317/318/319.
  - Coax contact extraction tool = Z80-290.
  - Recommended hand crimp tool for inner coax contact = Z80-292 with positioner Z80-291. Recommended hand crimp tool and die set for sleeve = Z80-293.
  - Instruction sheets are available.
  - M80-5000000MA-06-XXX-00-000 is shown for illustrative purposes only, see order code for variants.

<p>www.harwin.com</p>	This drawing and any information or descriptive matter set out hereon are confidential and copyright property of the Harwin group and must not be disclosed, loaned, copied or used for manufacturing, tendering or for any other purpose without their written permission.	TOLERANCES X. = ±0.50mm X.X = ±0.30mm X.XX = ±0.10mm X.XXX = ±0.01mm Angles = ±5° Unless stated	Third angle projection 	MATERIAL: See Specifications	Title: Datamate Mix Tek Male Plug Reverse Fix Slotted Jackscrew Connector
		Sheet scale: 5:1 Do not scale Sheet size: A3	FINISH: See Specifications	Drawing number: <b>M80-5000000MA-XX-XXX-00-000</b>	SHT 5 OF 8

# Customer Information Sheet

Specifications:  
 Material:  
 Housing: Glass Filled PPS, UL94V-0, Black  
 Power Contact:  
 Body, Sleeve, Inner Contact, End Plug = Copper Alloy  
 Latching Collar = Beryllium Copper  
 Insulator = PTFE  
 Board Mount Jackscrew, Nut = Stainless Steel  
 Finish:  
 Power Contact:  
 Body, Sleeve, Inner Contact, End Plug = Gold  
 Latching Collar = Nickel  
 Packing:  
 Bag  
 For Complete Specification See Component Specification C005XX (Latest Issue)

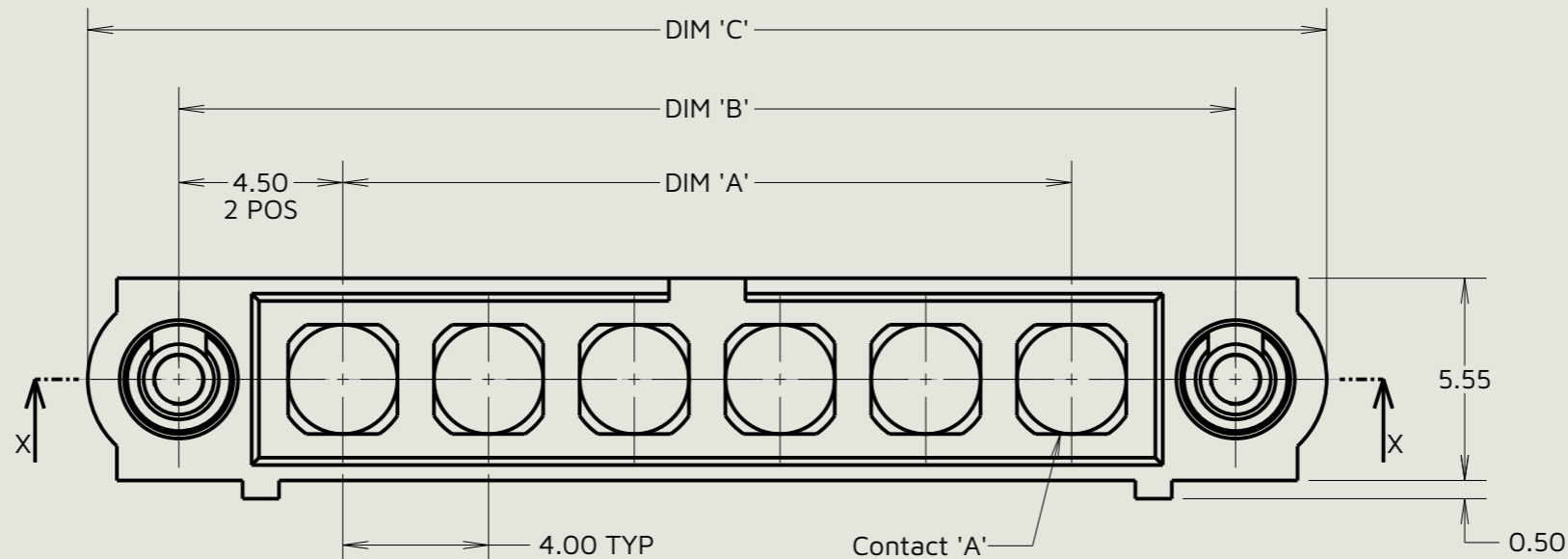

**Crimp and Solder Contacts Only**

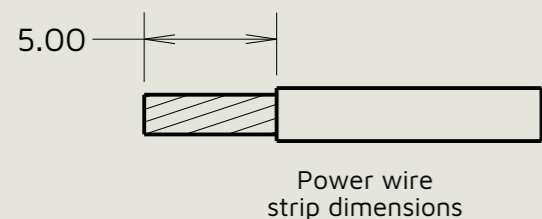
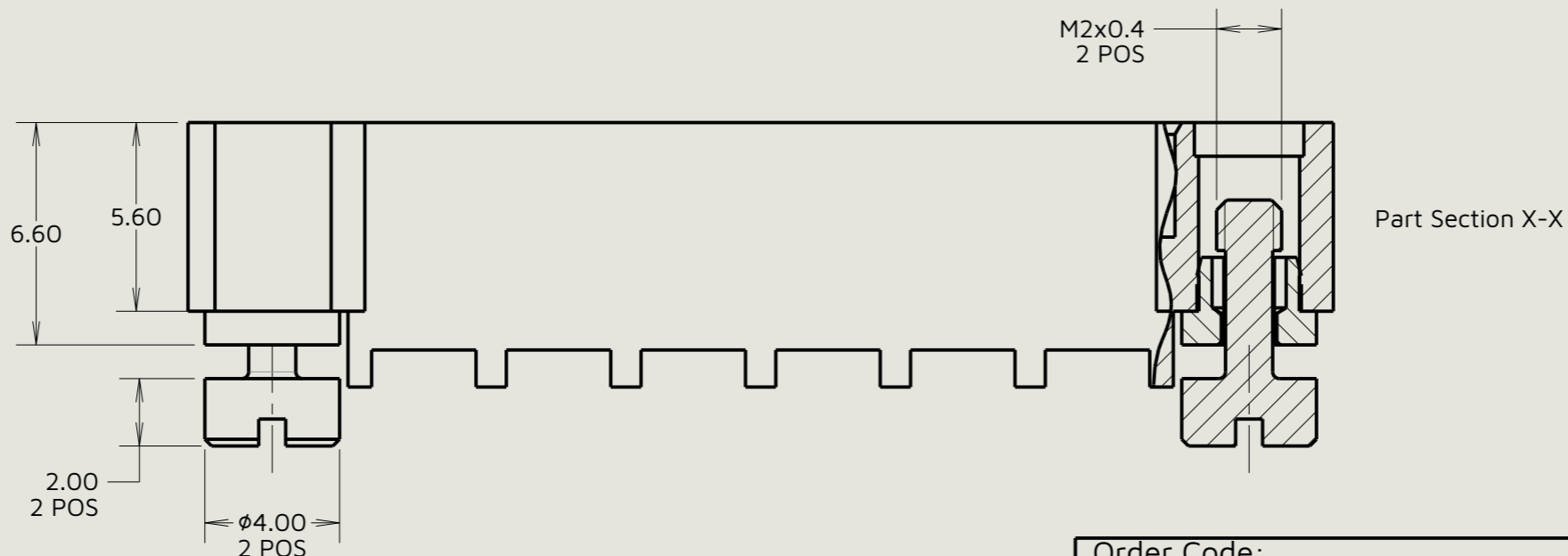

Dimension	Calculation
DIM 'A'	4 x No. Of Contacts - 4.00
DIM 'B'	4 x No. Of Contacts + 5.00
DIM 'C'	4 x No. Of Contacts + 10.0

Order Code:  
**M80-5000000MA-XX-XXX-00-000**  
 Total No. Of Contacts: \_\_\_\_\_  
 02 To 12  
 Special Contacts: \_\_\_\_\_  
 335 = Power Contact 12AWG Solder M80-335  
 336 = Power Contact 14AWG Solder M80-336  
 337 = Power Contact 16AWG Solder M80-337  
 338 = Power Contact 18AWG Solder/Crimp M80-338  
 339 = Power Contact 20AWG Solder/Crimp M80-339  
 PM5 = Power Contact 10AWG Solder M80-PM5

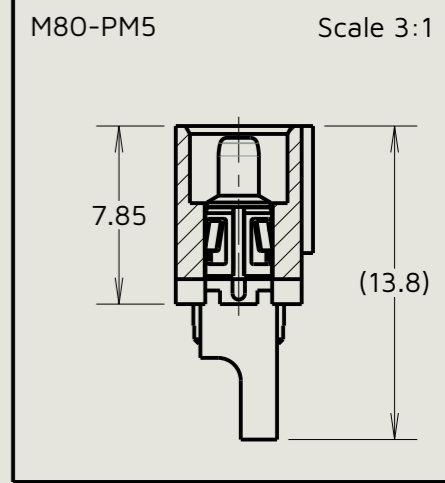
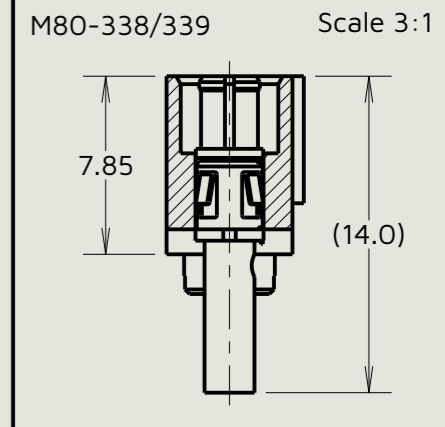
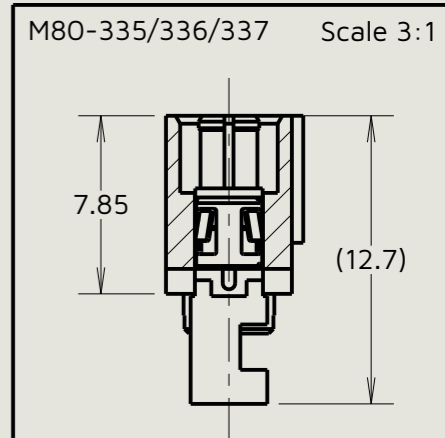

MJ	5	28.01.26	37709
Initials	Rev.	Date	CO
SB	1	19.08.11	11275

Notes:  
 1. Connectors are supplied with contacts loose.  
 2. For extra power contacts use part numbers M80-335/336/337/338/339/PM5.  
 3. Power contact extraction tool = Z80-290.  
 4. Recommended hand crimp tool for contacts M80-338/339 = Z80-294 and positioner Z80-295.  
 5. Instruction sheets are available.  
 6. M80-5000000MA-06-XXX-00-000 is shown for illustration purposes only, see order code for variants.

 www.harwin.com	This drawing and any information or descriptive matter set out hereon are confidential and copyright property of the Harwin group and must not be disclosed, loaned, copied or used for manufacturing, tendering or for any other purpose without their written permission.	TOLERANCES X. = ±0.50mm X.X = ±0.30mm X.XX = ±0.10mm X.XXX = ±0.01mm Angles = ±5° Unless stated	Third angle projection  Sheet scale: 5:1 Do not scale Sheet size: A3	MATERIAL: See Specifications FINISH: See Specifications	Title: Datamate Mix Tek Male Plug Reverse Fix Slotted Jackscrew Connector Drawing number: <b>M80-5000000MA-XX-XXX-00-000</b>
		SHT 6 OF 8			

# Customer Information Sheet

**Specifications:**

**Material:**  
 Housing: Glass Filled PPS, UL94V-0, Black  
 Power Contact: Copper Alloy  
 Coax Contact:  
 Body = Copper Alloy  
 Inner Contact = Copper Alloy  
 Insulator = PTFE  
 Board Mount Jackscrew, Nut = Stainless Steel

**Finish:**  
 Power Contact: Gold  
 Coax Contact: Body, Inner Contact = Gold  
**Packing:**  
 Tube  
 For Complete Specification See Component Specification C005XX (Latest Issue)

## PC Tail Contacts Only

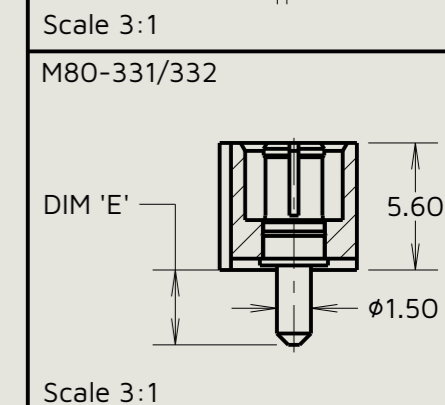
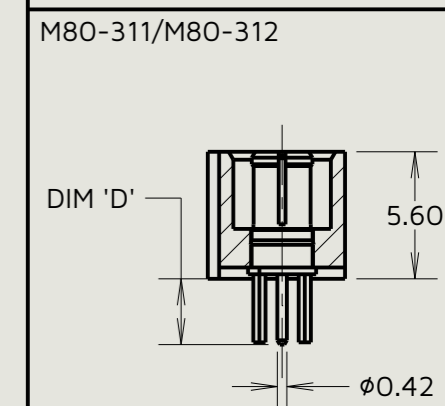
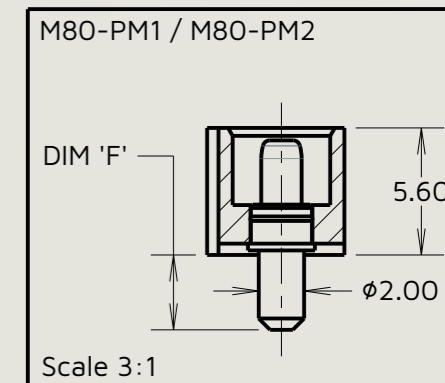
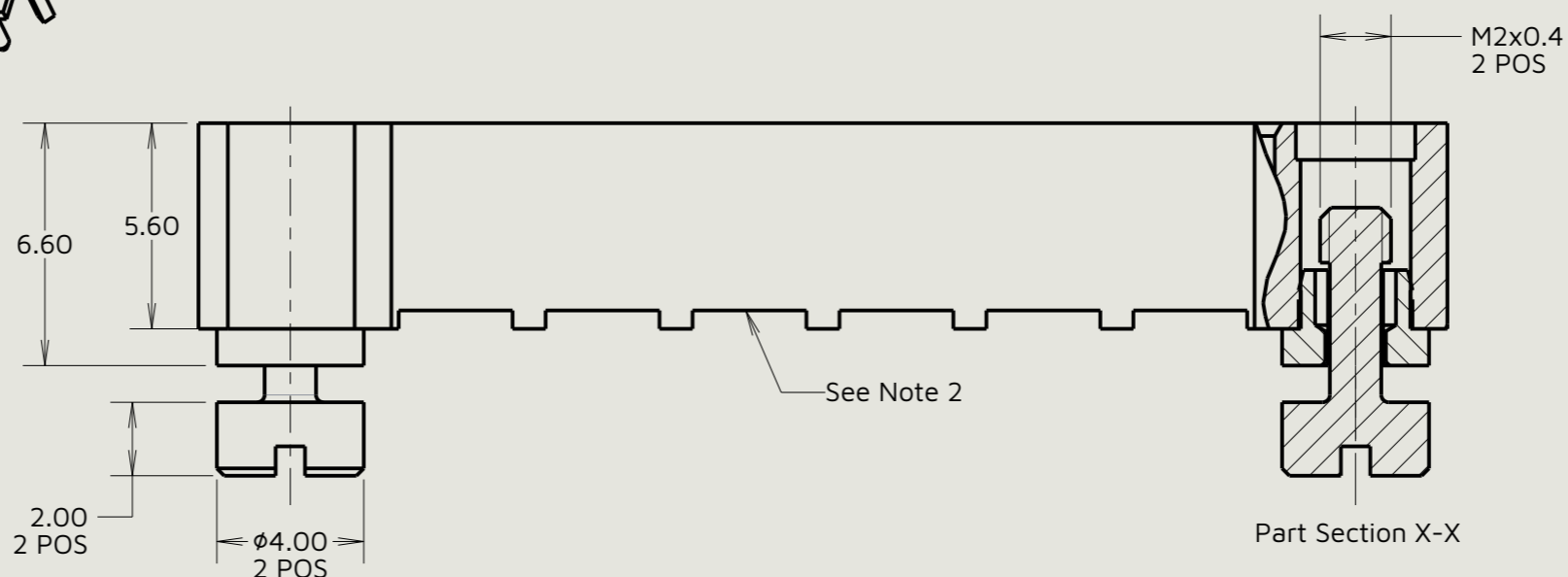
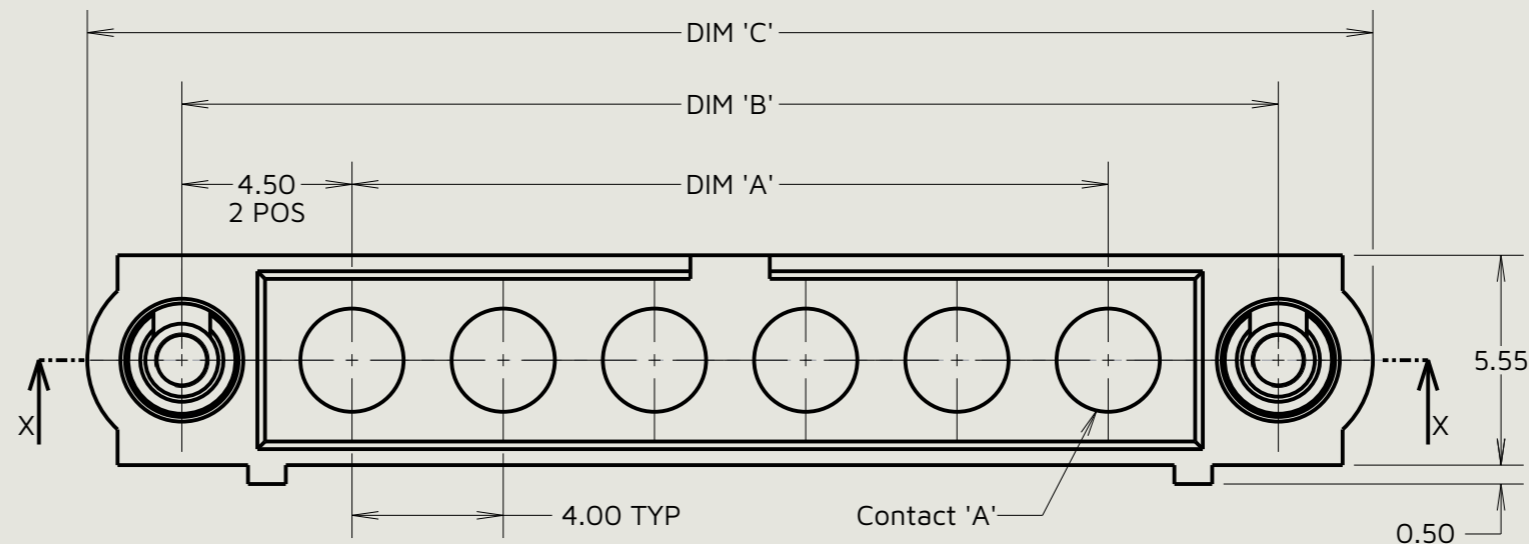
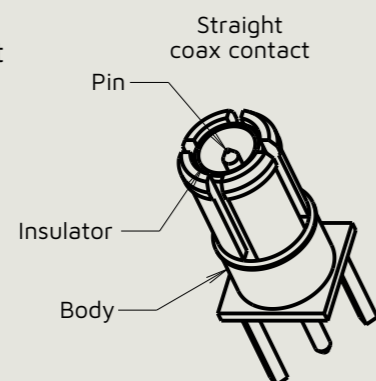

Dimension	Calculation
DIM 'A'	4 x No. Of Contacts - 4.00
DIM 'B'	4 x No. Of Contacts + 5.00
DIM 'C'	4 x No. Of Contacts + 10.0
DIM 'D'	M80-311 = 2.9mm, M80-312 = 4.4mm
DIM 'E'	M80-331 = 3.3mm, M80-332 = 4.8mm
DIM 'F'	M80-PM1 = 3.3mm, M80-PM2 = 4.8mm

**Order Code:**  
**M80-5000000MA-XX-XXX-00-000**

Total No. Of Contacts: \_\_\_\_\_  
 02 To 12

Special Contacts: \_\_\_\_\_

311 = Coax Contact 3.0mm PC Tail M80-311  
 312 = Coax Contact 4.5mm PC Tail M80-312  
 331 = 20A Power Contact 3.5mm Straight PC Tail M80-331  
 332 = 20A Power Contact 5.0mm Straight PC Tail M80-332  
 PM1 = 40A Power Contact 3.5mm Straight PC Tail M80-PM1  
 PM2 = 40A Power Contact 5.0mm Straight PC Tail M80-PM2

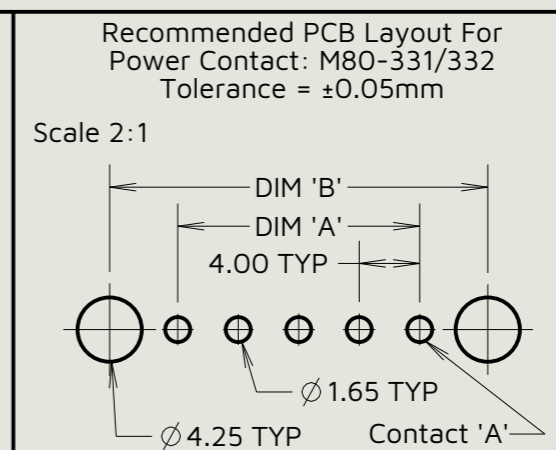
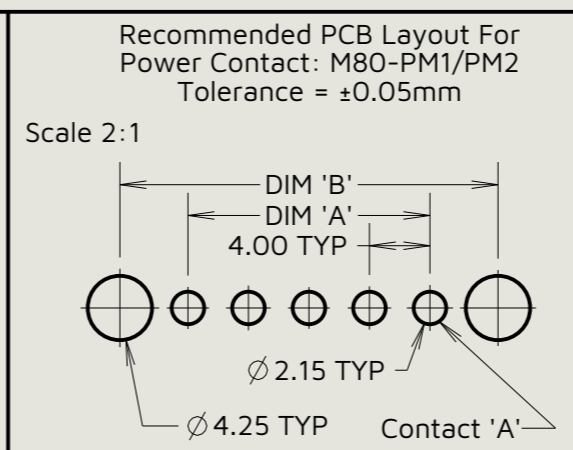
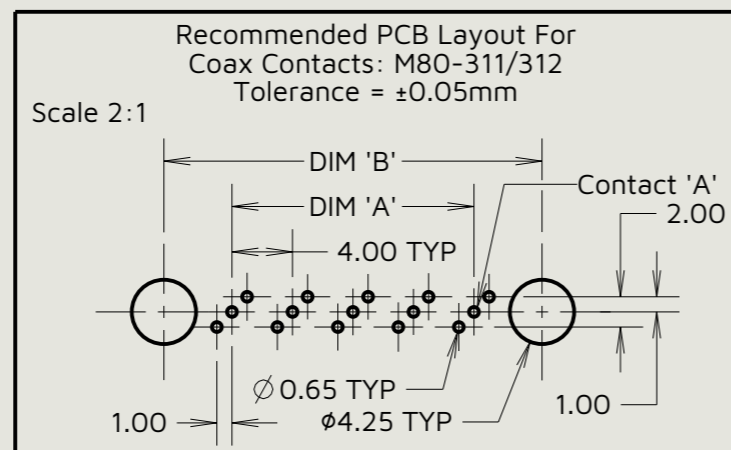

MJ	5	28.01.26	37709
Initials	Rev.	Date	CO
SB	1	19.08.11	11275

**Notes:**  
 1. M80-5000000MA-06-XXX-00-000 is shown for illustration purposes only, see order code for variants.  
 2. Contacts are hidden for illustration purposes.

	This drawing and any information or descriptive matter set out hereon are confidential and copyright property of the Harwin group and must not be disclosed, loaned, copied or used for manufacturing, tendering or for any other purpose without their written permission.	<b>TOLERANCES</b> X. = ±0.50mm X.X = ±0.30mm X.XX = ±0.10mm X.XXX = ±0.01mm Angles = ±5° Unless stated	Third angle projection 	<b>MATERIAL:</b> See Specifications	Title: Datamate Mix Tek Male Plug Reverse Fix Slotted Jackscrew Connector
		Sheet scale: 5:1 Do not scale Sheet size: A3	<b>FINISH:</b> See Specifications	Drawing number: <b>M80-5000000MA-XX-XXX-00-000</b>	SHT 7 OF 8

# Customer Information Sheet

Recommended PCB Layout For Power SMT  
Tolerance = ±0.05mm, Scale 3:1  
Solder Pads Shown Below

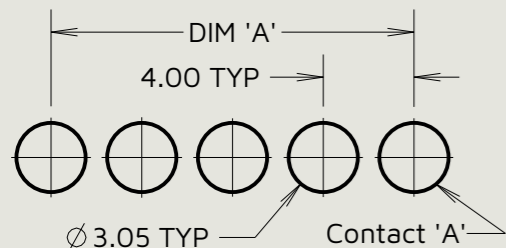

Scale 3:1

Recommended PCB Layout For Power M80-333/334  
Tolerance = ±0.05mm, Scale 3:1  
Through Holes Shown Below

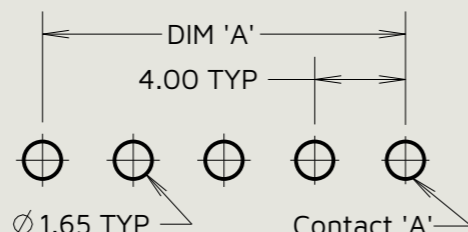

Scale 3:1

Recommended PCB Layout For Power Contacts: M80-PM3/PM4  
Tolerance = ±0.05mm, Scale 3:1  
Through Holes Shown Below

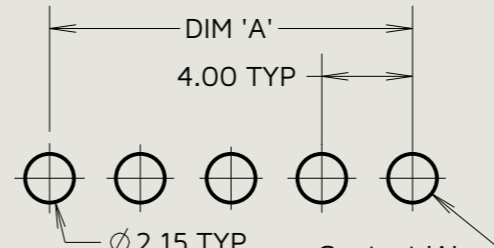

Scale 3:1

Recommended PCB Layout For Coax Contacts: M80-313/314  
Tolerance = ±0.05mm, Scale 3:1  
Through Holes Shown Below

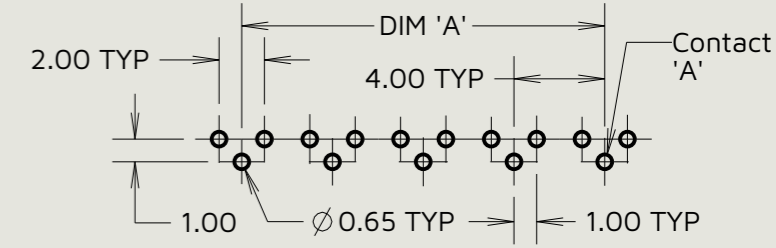

Scale 3:1

Specifications:  
Material:  
Housing: Glass Filled PPS, UL94V-0, Black  
Power Contact: Copper Alloy  
Coax Contact:  
Body = Copper Alloy  
Inner Contact = Copper Alloy  
Insulator = PTFE  
Board Mount Jackscrew, Nut = Stainless Steel  
Finish:  
Power Contact: Gold  
Coax Contact: Body, Inner Contact = Gold  
Packing:  
Tube  
For Complete Specification See Component Specification C005XX (Latest Issue)

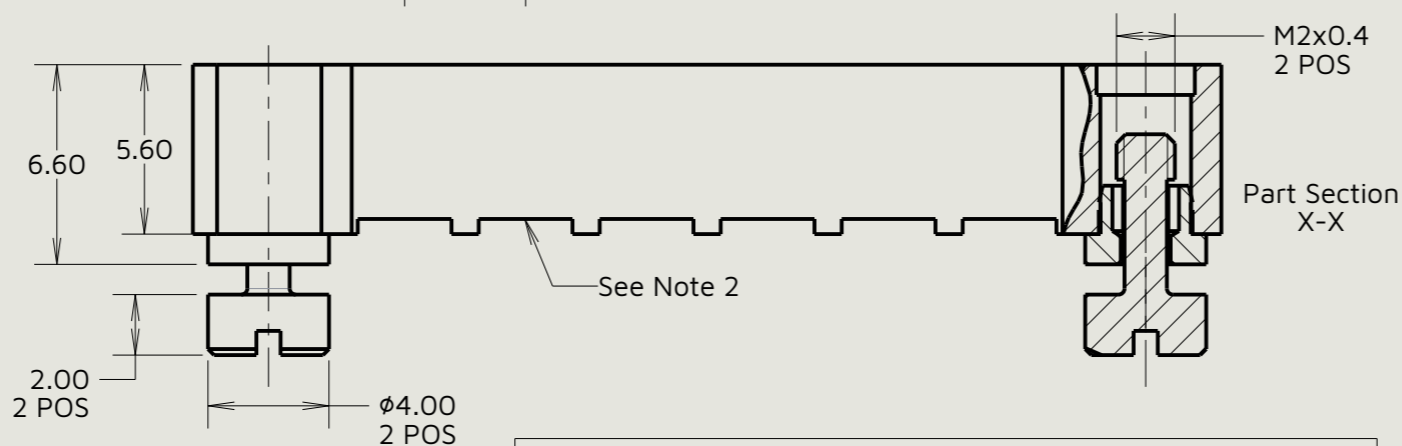
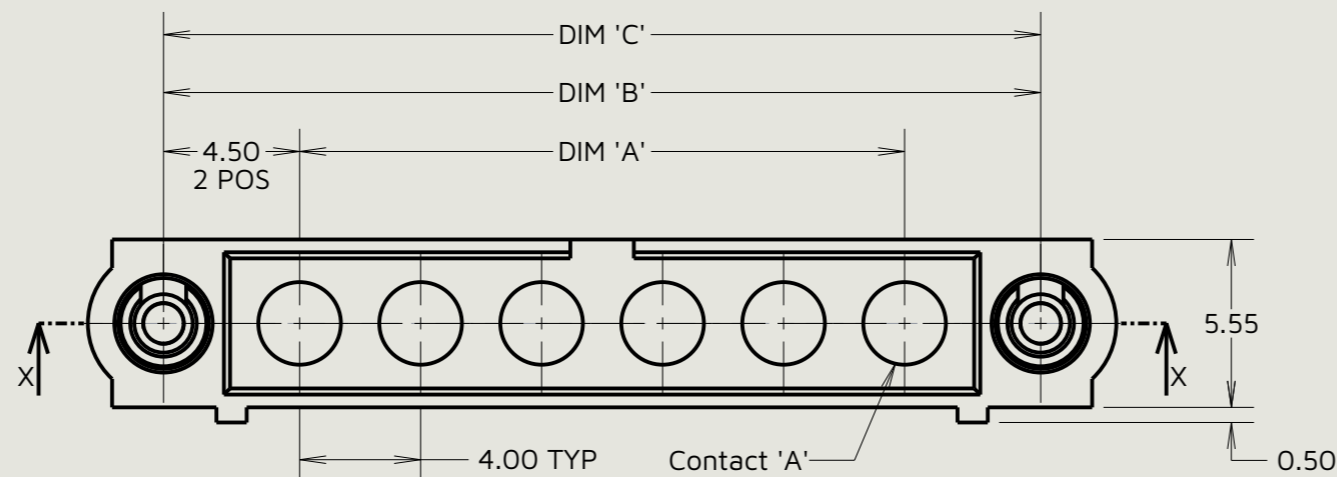

PC Tail and SMT  
Contacts Only

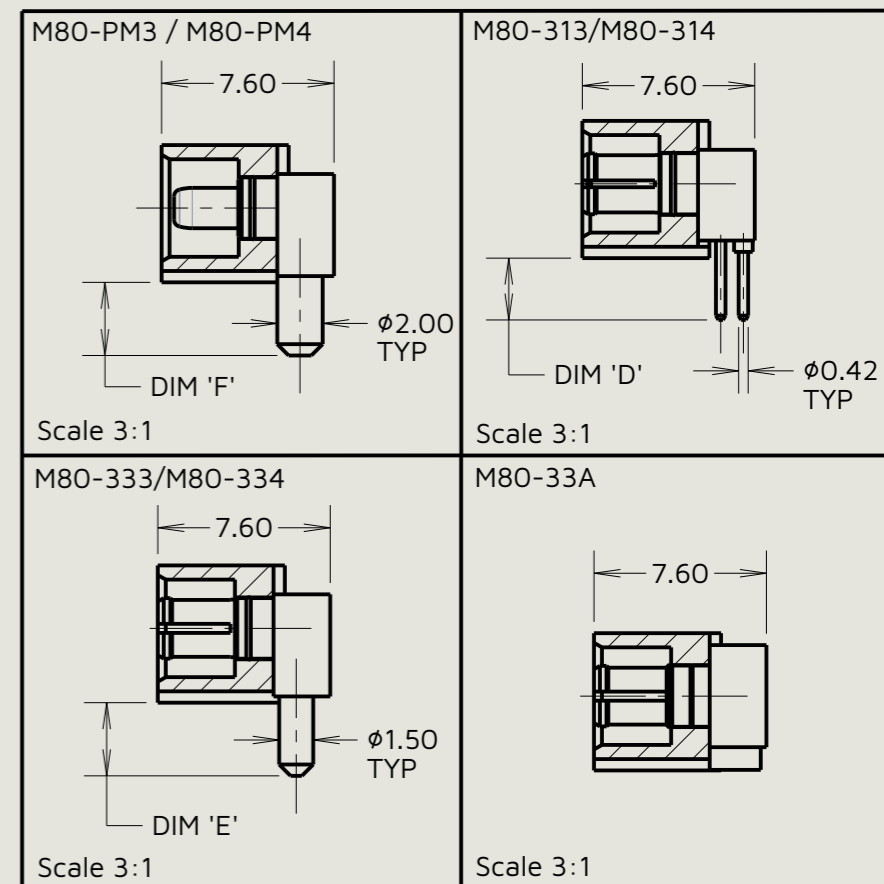

Order Code:  
**M80-5000000MA-XX-XXX-00-000**

Total No. Of Contacts: \_\_\_\_\_  
02 To 12

Special Contacts: \_\_\_\_\_  
313 = Coax Contact 3.0mm PC Tail M80-313  
314 = Coax Contact 4.5mm PC Tail M80-314  
333 = 20A Power Contact 3.5mm Right Angle PC Tail M80-333  
334 = 20A Power Contact 5.0mm Right Angle PC Tail M80-334  
PM3 = 40A Power Contact 3.5mm Right Angle PC Tail M80-PM3  
PM4 = 40A Power Contact 5.0mm Right Angle PC Tail M80-PM4  
33A = Power Contact Right Angle SMT M80-33A

Dimension	Calculation
DIM 'A'	4 x No. Of Contacts - 4.00
DIM 'B'	4 x No. Of Contacts + 5.00
DIM 'C'	4 x No. Of Contacts + 10.0
DIM 'D'	M80-313 = 2.7mm, M80-314 = 4.2mm
DIM 'E'	M80-333 = 3.2mm, M80-334 = 4.7mm
DIM 'F'	M80-PM3 = 3.2mm, M80-PM4 = 4.7mm

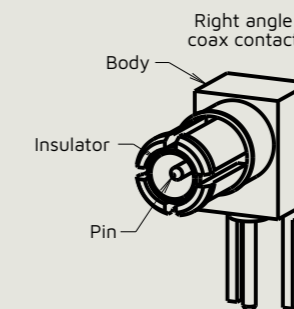

MJ	5	28.01.26	37709
Initials	Rev.	Date	CO
SB	1	19.08.11	11275

Notes:  
1. M80-5000000MA-06-XXX-00-000 is shown for illustration purposes only, see order code for variants.  
2. Contacts are hidden for illustration purposes.

**HARWIN**  
www.harwin.com

This drawing and any information or descriptive matter set out hereon are confidential and copyright property of the Harwin group and must not be disclosed, loaned, copied or used for manufacturing, tendering or for any other purpose without their written permission.

TOLERANCES  
X. = ±0.50mm  
X.X = ±0.30mm  
X.XX = ±0.10mm  
X.XXX = ±0.01mm  
Angles = ±5°  
Unless stated

Third angle projection  
  
Sheet scale: 4:1  
Do not scale  
Sheet size: A3

MATERIAL:  
See Specifications  
FINISH:  
See Specifications

Title:  
Datamate Mix Tek Male Plug Reverse Fix Slotted Jackscrew Connector  
Drawing number:  
**M80-5000000MA-XX-XXX-00-000**  
SHT 8 OF 8