

# Customer Information Sheet

IF IN DOUBT - ASK

©

NOT TO SCALE

THIRD ANGLE PROJECTION

ALL DIMENSIONS IN mm

ORDER CODE: **G125-MHXXX05L3P**

CONTACT STYLE:  
 3.2mm PC-TAIL = H1  
 4.7mm PC-TAIL = H2

TOTAL No. OF CONTACTS:  
 06, 10, 12, 16, 20, 26, 34, 50

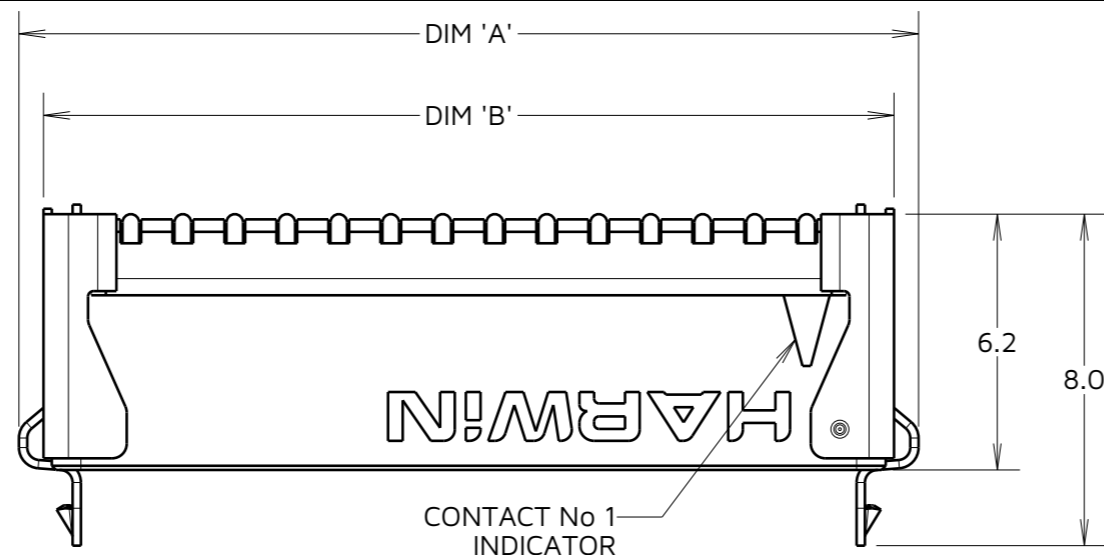
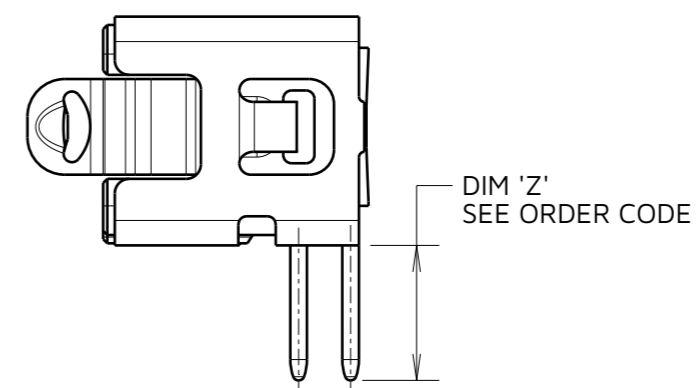
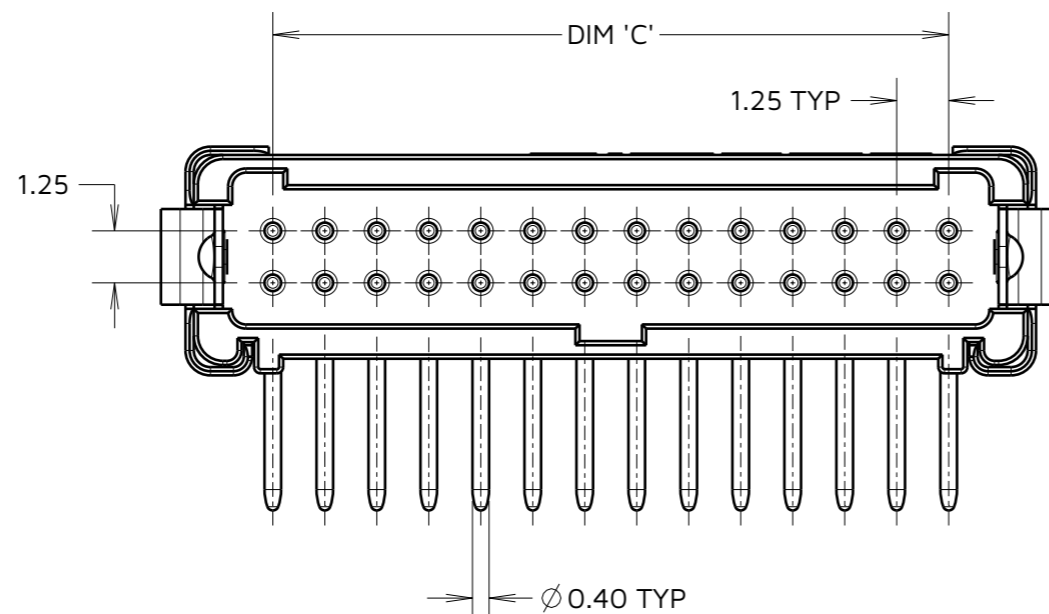
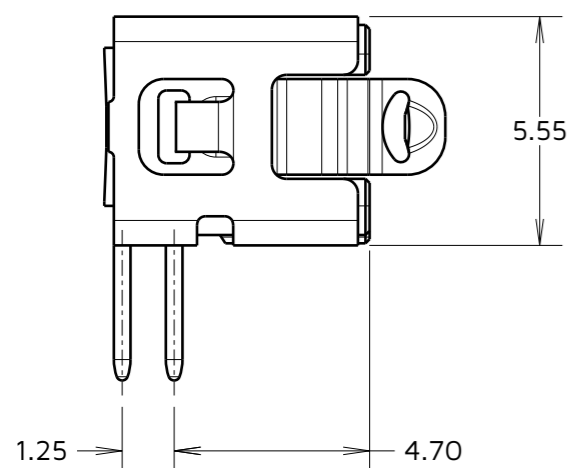
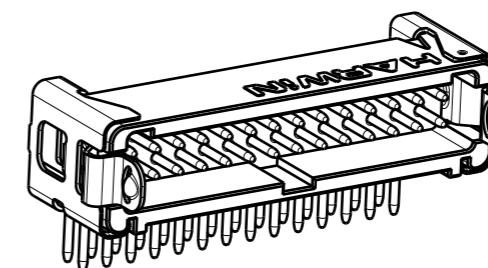
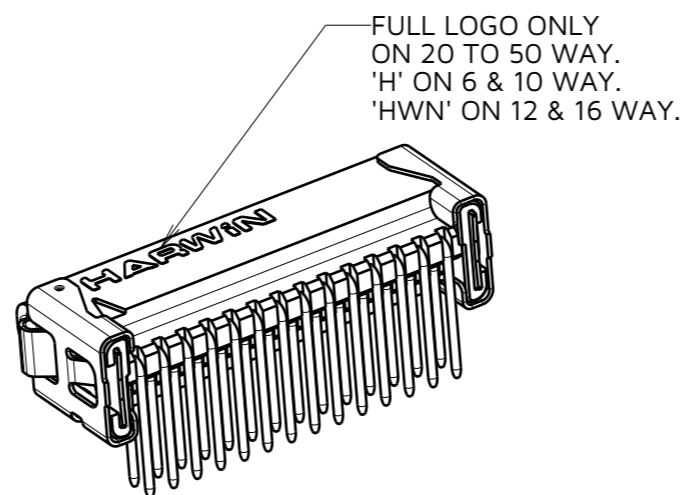
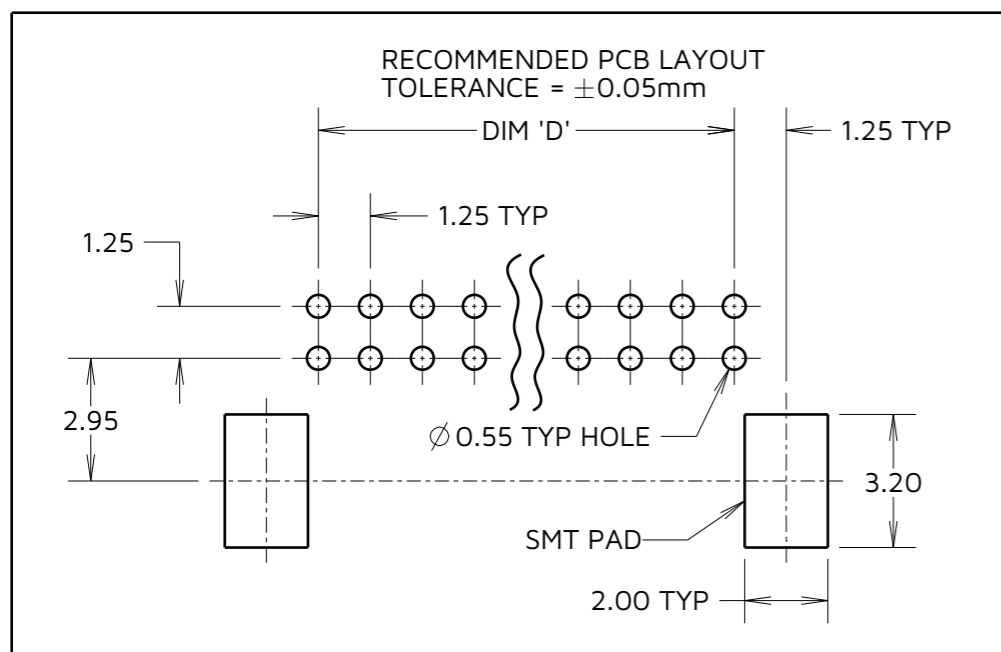

TABLE 1: DIMENSION VARIANTS				
PART No.	DIM 'A'	DIM 'B'	DIM 'C'	DIM 'D'
G125-MHX0605L3P-00	8.05	6.80	2.50	2.50
G125-MHX1005L3P-00	10.55	9.30	5.00	5.00
G125-MHX1205L3P-00	11.80	10.55	6.25	6.25
G125-MHX1605L3P-00	14.30	13.05	8.75	8.75
G125-MHX2005L3P-00	16.80	15.55	11.25	11.25
G125-MHX2605L3P-00	20.55	19.30	15.00	15.00
G125-MHX3405L3P-00	25.55	24.30	20.00	20.00
G125-MHX5005L3P-00	35.55	34.30	30.00	30.00



CONNECTOR DETAILS  
 AND PCB LAYOUT ONLY.  
 SEE SHEET 6  
 FOR TAPE STRIP DETAILS.



NOTES:  
 1. FOR COMPLETE SPECIFICATION, SEE COMPONENT SPECIFICATION C125XX (LATEST ISSUE).

MJ	6	17.10.24	34985
NAME	ISS.	DATE	CN/CO
APPROVED:		M. JELLEY	
CHECKED:		A. BOXALL	
DRAWN:		MARK G PLESTED	

**HARWIN**  
 www.harwin.com

TOLERANCES  
 X. = ±1mm  
 X.X = ±0.50mm  
 X.XX = ±0.20mm  
 X.XXX = ±0.01mm  
 ANGLES = ±5°  
 UNLESS STATED

THIS DRAWING AND ANY INFORMATION OR DESCRIPTIVE MATTER SET OUT HEREON ARE CONFIDENTIAL AND COPYRIGHT PROPERTY OF THE HARWIN GROUP AND MUST NOT BE DISCLOSED, LOANED, COPIED OR USED FOR MANUFACTURING, TENDERING OR FOR ANY OTHER PURPOSE WITHOUT THEIR WRITTEN PERMISSION.

MATERIAL & FINISH:  
 SEE NOTE 1

TITLE: **GECKO LATCH MALE HORIZONTAL PC TAIL CONNECTOR ASSEMBLY**

DRAWING NUMBER:  
**G125-MHXXX05L3P**

SHT  
 5 OF 6

# Customer Information Sheet

IF IN DOUBT - ASK

©

NOT TO SCALE

THIRD ANGLE PROJECTION

ALL DIMENSIONS IN mm

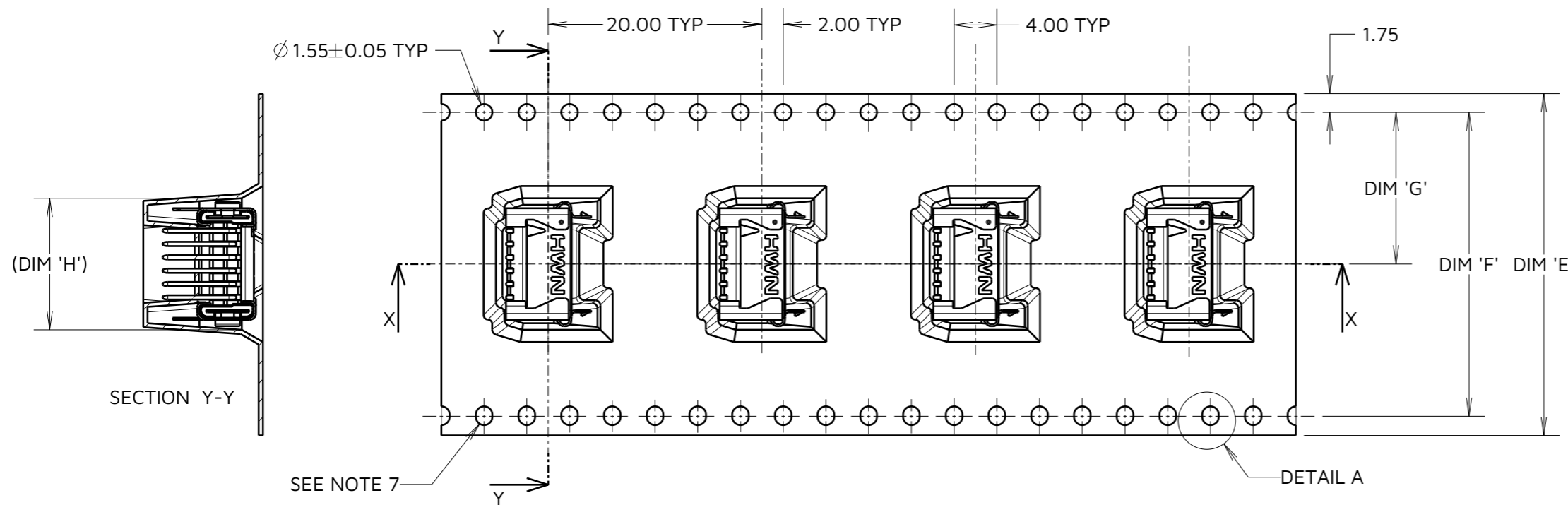

ORDER CODE: G125-MHXXX05L3P

CONTACT STYLE:  
3.2mm PC-TAIL = H1  
4.7mm PC-TAIL = H2

TOTAL No. OF CONTACTS:  
06, 10, 12, 16, 20, 26, 34, 50

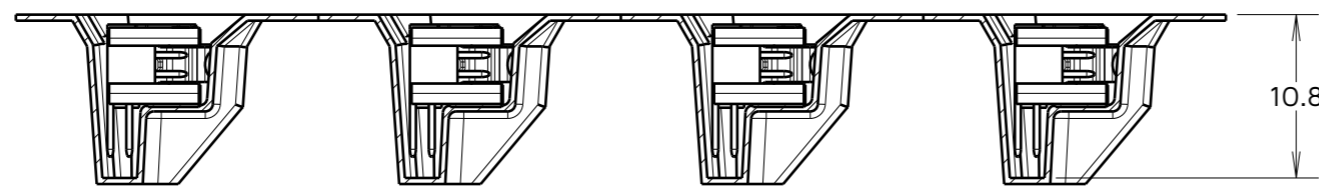
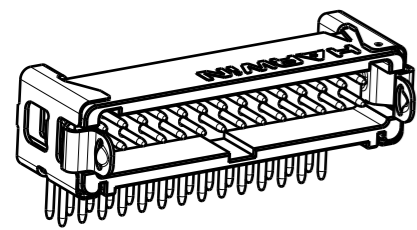

SECTION X-X

ELONGATED SPROCKET HOLE

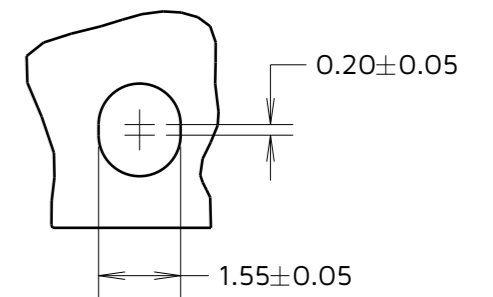

DETAIL A  
SEE NOTE 7

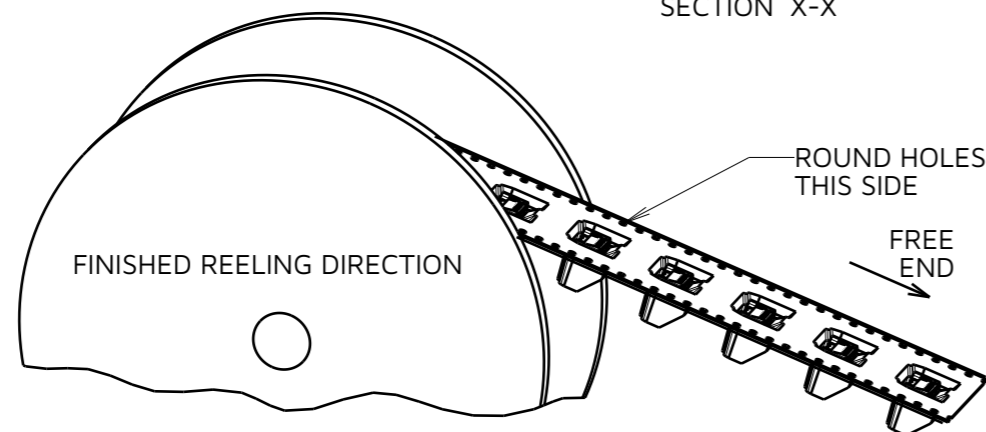
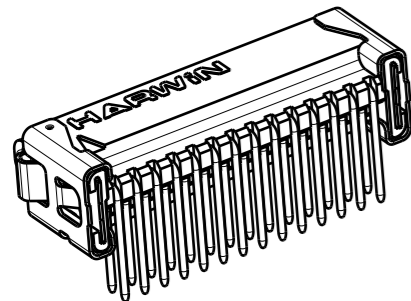

NOTES:

- COMPONENTS ARE ORIENTED IN TAPE POCKETS AS SHOWN.
- COMPONENTS ARE SUPPLIED IN STRIPS OF 10 UNLESS OTHERWISE SPECIFIED.
- LARGE QTY'S MAY BE SHIPPED ON A REEL AND MAY NOT HAVE A LEADER.
- FOR PARTS ON REEL SUITABLE FOR AUTOMATIC MACHINE PLACEMENT PLEASE ORDER: G125-MHXXX05L3R.
- FOR COMPLETE SPECIFICATION, SEE COMPONENT SPECIFICATION C125XX (LATEST ISSUE).
- ELONGATED SPROCKET HOLE NOT PRESENT ON 06 & 10 POSITIONS.
- SEE SHEET 5 FOR CONNECTOR DETAILS.

TABLE 2: DIMENSION VARIANTS

PART No.	DIM 'E'	DIM 'F'	DIM 'G'	(DIM 'H')
G125-MHX0605L3P	24.0	NO ELONGATED HOLE	11.50	8.5
G125-MHX1005L3P	+0.3/-0.1			11.0
G125-MHX1205L3P	32.0±0.3	28.40	14.20	12.2
G125-MHX1605L3P				14.7
G125-MHX2005L3P				17.2
G125-MHX2605L3P	44.0±0.3	40.40	20.2±0.15	21.0
G125-MHX3405L3P				26.0
G125-MHX5005L3P	56.0±0.3	52.40	26.2±0.15	36.0

MJ	6	17.10.24	34985
NAME	ISS.	DATE	CN/CO
APPROVED: M. JELLEY			
CHECKED: A. BOXALL			
DRAWN: MARK G PLESTED			

**HARWIN**

www.harwin.com

TOLERANCES  
X. = ±1mm  
X.X = ±0.50mm  
X.XX = ±0.20mm  
X.XXX = ±0.01mm  
ANGLES = ±5°  
UNLESS STATED

THIS DRAWING AND ANY INFORMATION OR DESCRIPTIVE MATTER SET OUT HEREON ARE CONFIDENTIAL AND COPYRIGHT PROPERTY OF THE HARWIN GROUP AND MUST NOT BE DISCLOSED, LOANED, COPIED OR USED FOR MANUFACTURING, TENDERING OR FOR ANY OTHER PURPOSE WITHOUT THEIR WRITTEN PERMISSION.

MATERIAL & FINISH:  
SEE SHEET 5

TITLE:  
G125 MALE HORIZONTAL PC TAIL SERIES IN TAPE

DRAWING NUMBER:  
G125-MHXXX05L3P

SHT  
6 OF 6