

Customer Information Sheet

SPECIFICATIONS:

MATERIAL:
MOULDING: GLASS FILLED PPS, UL94V-0, BLACK
SIGNAL CONTACT: BRASS
POWER CONTACT:
BODY = COPPER ALLOY
LATCHING COLLAR = BERYLLIUM COPPER
JACKSCREW: STAINLESS STEEL
FINISH:
SIGNAL CONTACT: GOLD
POWER CONTACT:
BODY = GOLD
LATCHING COLLAR = NICKEL
PACKING:
BAG
FOR COMPLETE SPECIFICATION SEE COMPONENT SPECIFICATION C005XX (LATEST ISSUE)

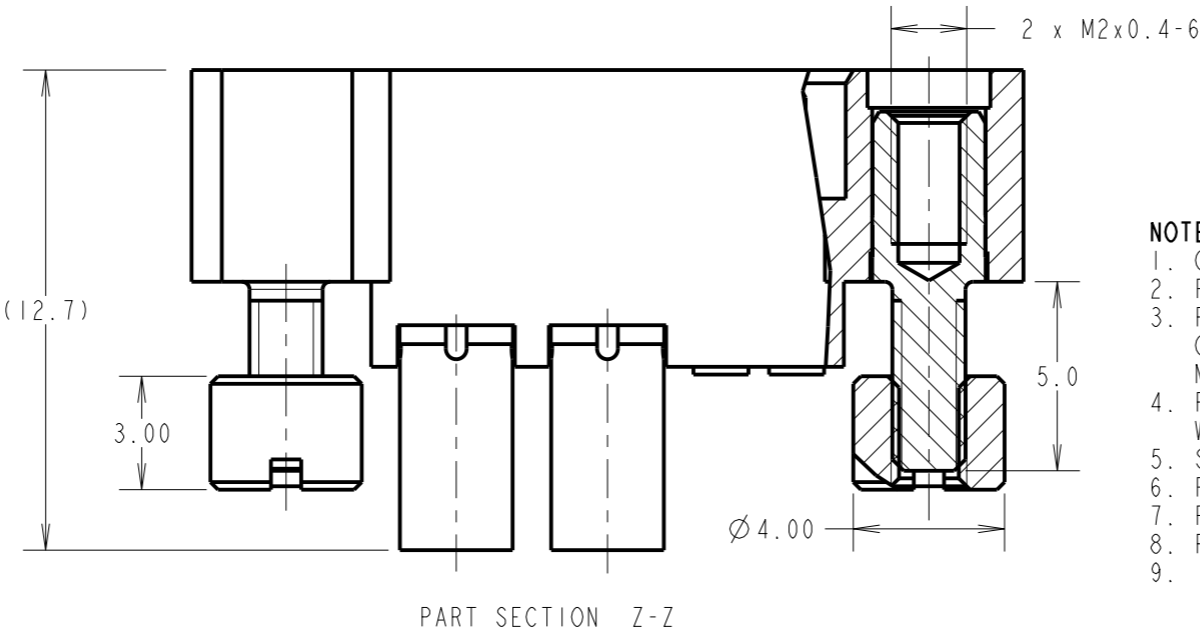
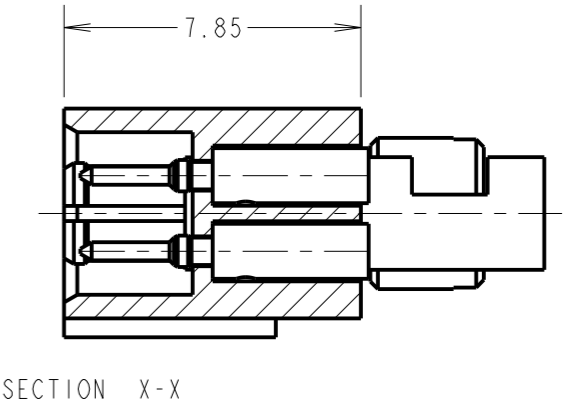
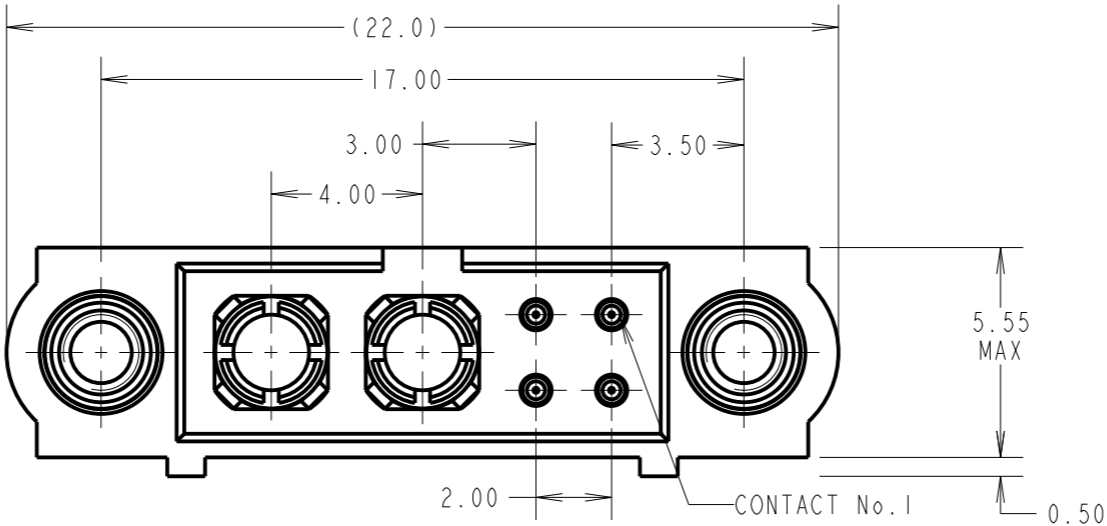

- NOTES:
- 1. CONNECTORS ARE SUPPLIED WITH CONTACTS LOOSE.
 - 2. FOR EXTRA SIGNAL CONTACTS, USE PART NUMBER M80-1940005.
 - 3. RECOMMENDED SIGNAL WIRE TYPE = 22 AWG. SEE COMPONENT SPECIFICATION C0049XX (LATEST ISSUE) FOR DETAILS.
MAX INSULATION DIAMETER = Ø1.10mm. STRIP WIRE BY 2.00MM FOR CRIMPING.
 - 4. RECOMMENDED HAND CRIMP TOOL FOR SIGNAL CONTACTS = M22520/2-01 WITH POSITIONER Z80-193.
 - 5. SIGNAL CONTACT INSERTION AND EXTRACTION TOOL = Z80-280.
 - 6. FOR EXTRA POWER CONTACTS, USE PART NUMBER M80-337
 - 7. POWER CONTACT WIRE, STRIP BY 5.00mm MINIMUM
 - 8. POWER CONTACT EXTRACTION TOOL = Z80-290
 - 9. INSTRUCTION SHEETS ARE AVAILABLE.

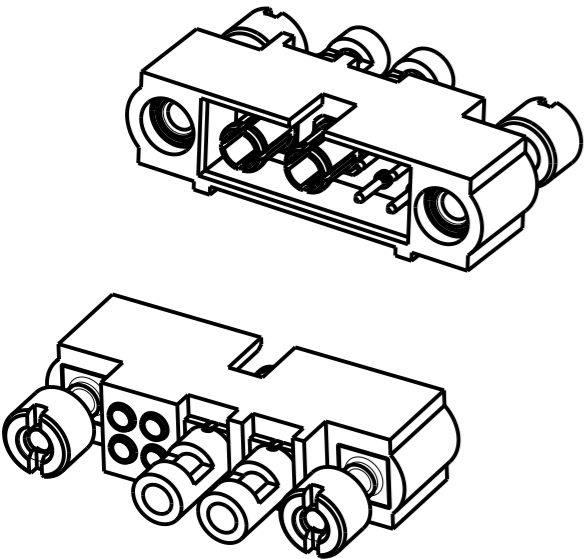
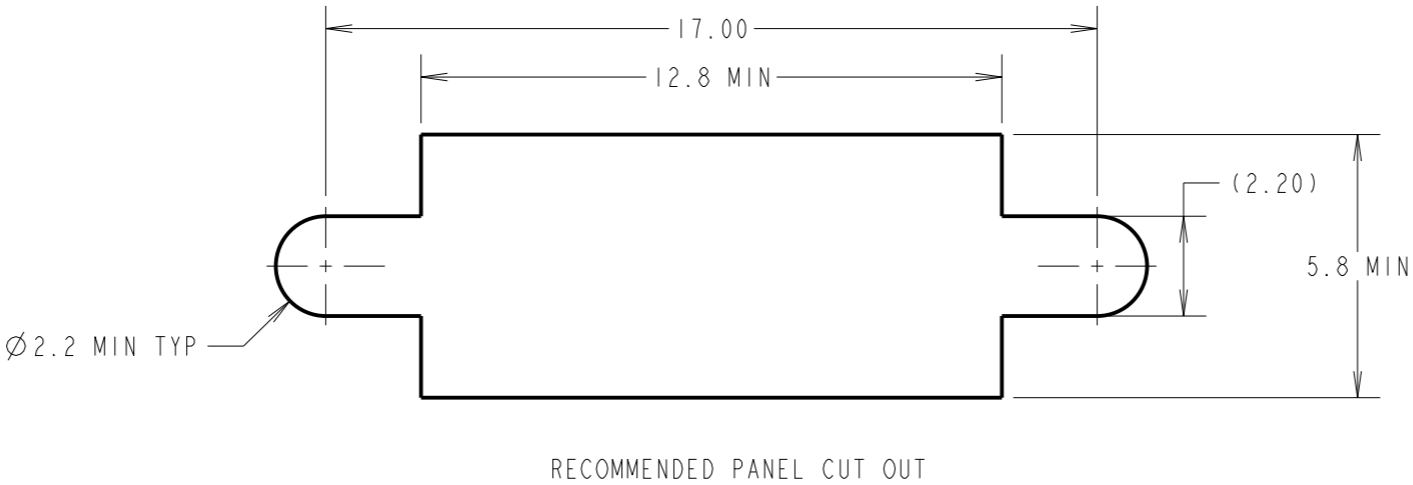

MGP	2	12.10.22	31948
NAME	ISS.	DATE	CN/CO
APPROVED: MGP			
CHECKED: MR			
DRAWN: R.ADDE			
CUSTOMER REF.:			
ASSEMBLY DRG:			



www.harwin.com
technical@harwin.com

THIS DRAWING AND ANY INFORMATION OR DESCRIPTIVE MATTER SET OUT HEREON ARE CONFIDENTIAL AND COPYRIGHT PROPERTY OF THE HARWIN GROUP AND MUST NOT BE DISCLOSED, LOANED, COPIED OR USED FOR MANUFACTURING, TENDERING OR FOR ANY OTHER PURPOSE WITHOUT THEIR WRITTEN PERMISSION.

TOLERANCES
X. = ±1mm
X.X = ±0.50mm
X.XX = ±0.20mm
X.XXX = ±0.01mm
ANGLES = ±5°
UNLESS STATED

MATERIAL:
SEE ABOVE
FINISH: SEE ABOVE
S/AREA: mm²

TITLE: JACKSCREW DATAMATE
MIXED TECHNOLOGY VERTICAL
CRIMP MALE ASSEMBLY
DRAWING NUMBER:
M80-5D10405M3-00-000-02-337
SHT 2 OF 2