

Customer Information Sheet

IF IN DOUBT - ASK



NOT TO SCALE

THIRD ANGLE PROJECTION

ALL DIMENSIONS IN mm

TABLE 1: CONFIGURATIONS & BILL OF MATERIALS

ORDER CODE CONFIGURATIONS										BOM ITEM No.								
										1	2	3	4	5	6	7	8	9
G125-XXXXX70XX-XXXXXX										CONNECTOR 1 (SEE ORDER CODE FOR TOTAL No. OF CONTACTS)	CONNECTOR 1 CONTACT (SEE ORDER CODE FOR QTY.)	CONNECTOR 1 BACKSHELL	SILVER- PLATED BRAID	BAND-IT TIE	WIRE	CONNECTOR 2 BACKSHELL	CONNECTOR 2 CONTACT (SEE ORDER CODE FOR QTY.)	CONNECTOR 2 (SEE ORDER CODE FOR TOTAL No. OF CONTACTS)
G125	-	FC FD	1	06 10 12 16 20 26 34 50	70	F1	-	XXXX	F1	G125-224XX9600	G125-0010005 G125-0020005	G125-964XXF1				G125-964XXF1	G125-0010005 G125-0020005	G125-224XX9600
		MC MD	2			M1 M3			M1 M3 F1	G125-324XX96M1 G125-324XX9600 (FOR M3)	G125-1010005 G125-1020005	G125-964XX00 G125-964XXF1 (FOR M3)	SEE C049XX	M80-9470000 M80-9480000	SEE C049XX	G125-964XX00 G125-964XXF1 (FOR F1 & M3)	G125-1010005 G125-1020005	G125-324XX96M1 G125-324XX9600 (FOR F1 & M3)

ORDER CODE:

G125-XXXXX70XX-XXXXXX

CONNECTOR 1:
F = FEMALE
M = MALE

WIRING STYLE:
C = STANDARD WIRE
D = TWISTED PAIR

WIRE GAUGE:
1 = 26AWG
2 = 28AWG

TOTAL No. OF CONTACTS:
06, 10, 12, 16,
20, 26, 34, 50

CONNECTOR 2 FIXING STYLE:
F1 = SCREW LOK
M1 = SCREW LOK
M3 = SCREW LOK REVERSE FIX

DIM 'A' LENGTH:
0060 = 60mm MIN
9999 = 9999mm MAX

CONNECTOR 1 FIXING STYLE:
F1 = SCREW LOK
M1 = SCREW LOK
M3 = SCREW LOK REVERSE FIX

70 = SILVER-PLATED
BRAIDING
(SEE NOTE 1)

NOTES:

- FOR COMPLETE SPECIFICATION, INCLUDING WIRE TYPE AND GAUGE SEE COMPONENT SPECIFICATIONS C125XX & C049XX (LATEST ISSUES).
- FOR POTTING COMPOUND AND WIRE TYPE SEE C049XX COMPONENT SPECIFICATION.
- SEE SHEET 7 FOR ASSEMBLIES WITH STANDARD WIRING CONFIGURATIONS.
- SEE SHEET 8 FOR ASSEMBLIES WITH TWISTED PAIR WIRING CONFIGURATIONS.
- SEE SHEET 9 FOR HARDWARE FIXING INFORMATION.
- WIRING OF CONNECTOR:
CONTACT 1 TO CONTACT 1
CONTACT 2 TO CONTACT 2, ETC.
- FOR ALL HOUSING DIMENSIONS, SEE RESPECTIVE DRAWINGS FOR BOM ITEMS 1&9.

RTP	1	31.07.24	34508
NAME	ISS.	DATE	CN/CO
APPROVED: A.BOXALL			
CHECKED: A.YEOMANS			
DRAWN: R.PORTLOCK			
ASSEMBLY DRG:			

HARWIN

www.harwin.com

TOLERANCES
X. = ±1mm
X.X = ±0.50mm
X.XX = ±0.20mm
X.XXX = ±0.01mm
ANGLES = ±5°
UNLESS STATED

THIS DRAWING AND ANY INFORMATION OR DESCRIPTIVE MATTER SET OUT HEREON ARE CONFIDENTIAL AND COPYRIGHT PROPERTY OF THE HARWIN GROUP AND MUST NOT BE DISCLOSED, LOANED, COPIED OR USED FOR MANUFACTURING, TENDERING OR FOR ANY OTHER PURPOSE WITHOUT THEIR WRITTEN PERMISSION.

MATERIAL:

SEE ABOVE

TITLE: G125 DOUBLE ENDED SHIELDED CABLE ASSEMBLIES w/ SILVER-PLATED BRAID

DRAWING NUMBER:
G125-XXXXX70XX-XXXXXX

SHT
6 OF 9

Customer Information Sheet

IF IN DOUBT - ASK

©

NOT TO SCALE

THIRD ANGLE PROJECTION

ALL DIMENSIONS IN mm

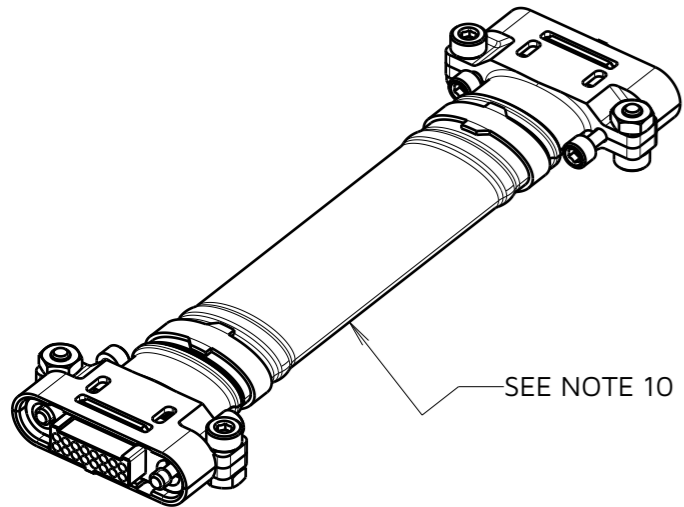
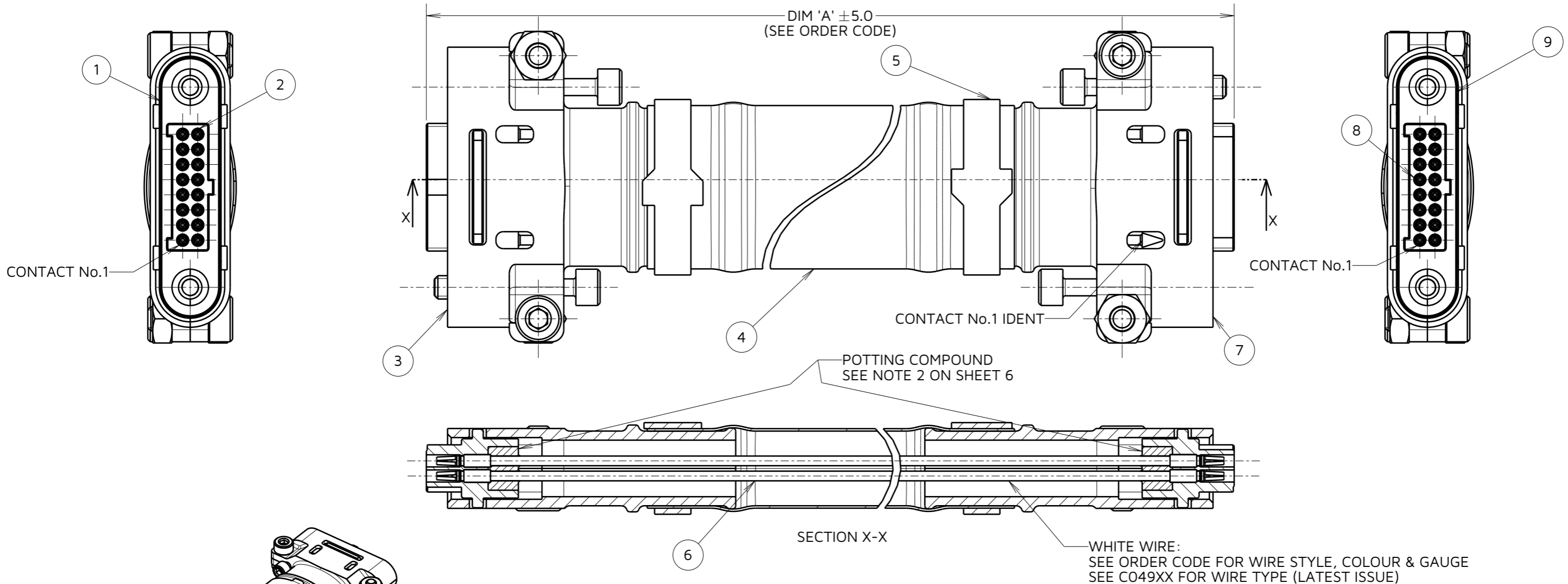

SEE NOTE 10

EXAMPLE SHOWN: FEMALE-TO-FEMALE
STANDARD WIRING
G125-FC11670F1-0150F1

ORDER CODE:

G125-XXXXX70XX-XXXXXX

CONNECTOR 1:
F = FEMALE
M = MALE

WIRING STYLE:
C = STANDARD WIRE
D = TWISTED PAIR

WIRE GAUGE:
1 = 26AWG
2 = 28AWG

TOTAL No. OF CONTACTS:
06, 10, 12, 16,
20, 26, 34, 50

CONNECTOR 2 FIXING STYLE:
F1 = SCREW LOK
M1 = SCREW LOK
M3 = SCREW LOK REVERSE FIX

DIM 'A' LENGTH:
0060 = 60mm MIN
9999 = 9999mm MAX

CONNECTOR 1 FIXING STYLE:
F1 = SCREW LOK
M1 = SCREW LOK
M3 = SCREW LOK REVERSE FIX

70 = SILVER-PLATED
BRAIDING
(SEE NOTE 1)

NOTES:

- 8. POSSIBLE CONFIGURATIONS:
FEMALE-TO-FEMALE
MALE-TO-MALE
MALE-TO-FEMALE
- 9. FOR POSSIBLE COMBINATIONS, SEE TABLE 1 ON SHEET 6.
- 10. ASSEMBLY G125-FC11670F1-0150F1 IS SHOWN FOR ILLUSTRATIVE PURPOSES.
SEE ORDER CODE FOR PART NUMBER.

RTP	1	31.07.24	34508
NAME	ISS.	DATE	CN/CO
APPROVED: A.BOXALL			
CHECKED: A.YEOMANS			
DRAWN: R.PORTLOCK			
ASSEMBLY DRG:			

HARWIN

www.harwin.com

TOLERANCES
X. = ±1mm
X.X = ±0.50mm
X.XX = ±0.20mm
X.XXX = ±0.01mm
ANGLES = ±5°
UNLESS STATED

THIS DRAWING AND ANY INFORMATION OR DESCRIPTIVE MATTER SET OUT HEREON ARE CONFIDENTIAL AND COPYRIGHT PROPERTY OF THE HARWIN GROUP AND MUST NOT BE DISCLOSED, LOANED, COPIED OR USED FOR MANUFACTURING, TENDERING OR FOR ANY OTHER PURPOSE WITHOUT THEIR WRITTEN PERMISSION.

MATERIAL:

SEE SHEET 6

TITLE: G125 DOUBLE ENDED
SHIELDED CABLE ASSEMBLIES
w/ SILVER-PLATED BRAID

DRAWING NUMBER:
G125-XXXXX70XX-XXXXXX

SHT
7 OF
9

Customer Information Sheet

IF IN DOUBT - ASK

©

NOT TO SCALE

THIRD ANGLE PROJECTION

ALL DIMENSIONS IN mm

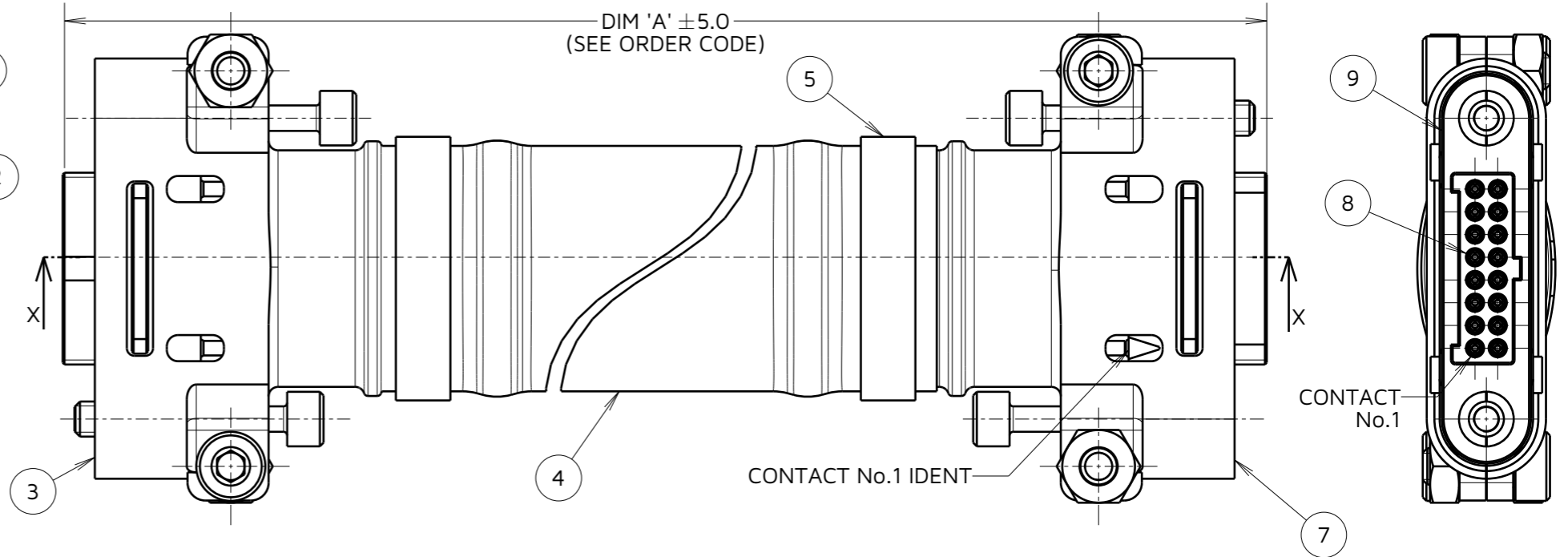
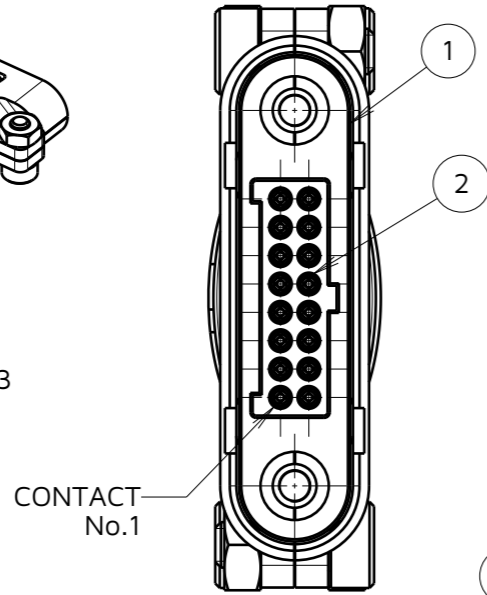
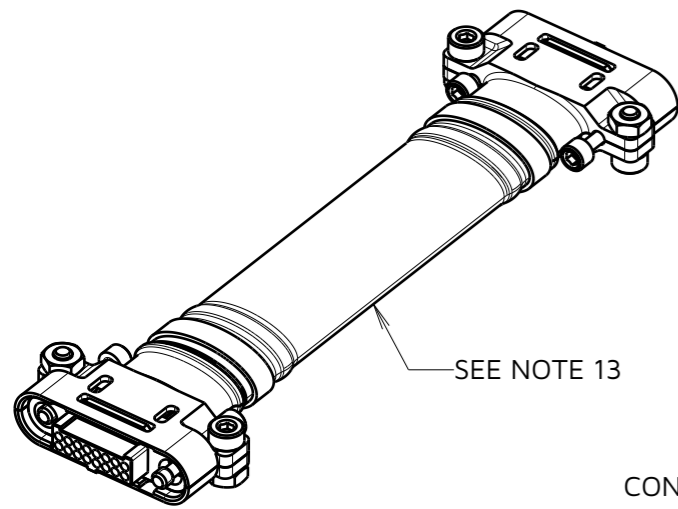
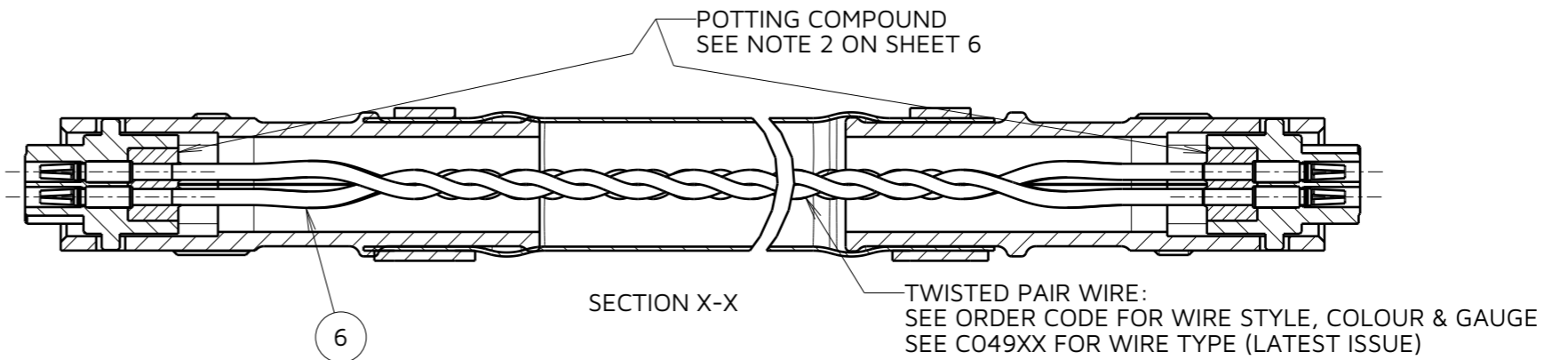

TABLE 2: TWISTED PAIR CABLE CONFIGURATIONS				
WIRING FOR EXAMPLE PART No. G125-FD11670F1-0150F1				
TWISTED PAIR No.	CONNECTOR 1 PIN No.	CONNECTOR 2 PIN No.	TURNS PER INCH	WIRE COLOUR
1	1	1	3	WHITE & GREEN
	9	9		
2	2	2	2	WHITE & RED
	10	10		
3	3	3	3	WHITE & GREEN
	11	11		
4	4	4	2	WHITE & RED
	12	12		
5	5	5	3	WHITE & GREEN
	13	13		
6	6	6	2	WHITE & RED
	14	14		
7	7	7	3	WHITE & GREEN
	15	15		
8	8	8	2	WHITE & RED
	16	16		

FOR CONNECTORS WITH MORE THAN 16 CONTACTS, CONTINUE TWIST & CABLE PIN OUT CONVENTION IN THE SAME PATTERN. (I.E. TWISTED PAIR BETWEEN CONTACT X & CONTACT X)

SEE BILL OF MATERIALS TABLE ON SHEET 6 FOR TWISTED PAIR PART NUMBERS.



EXAMPLE SHOWN: FEMALE-TO-FEMALE TWISTED PAIRS
G125-FD11670F1-0150F1

ORDER CODE:
G125-XXXXX70XX-XXXXXX

CONNECTOR 1: _____
 F = FEMALE
 M = MALE

WIRING STYLE: _____
 C = STANDARD WIRE
 D = TWISTED PAIR

WIRE GAUGE: _____
 1 = 26AWG
 2 = 28AWG

TOTAL No. OF CONTACTS: _____
 06, 10, 12, 16,
 20, 26, 34, 50

CONNECTOR 2 FIXING STYLE: _____
 F1 = SCREW LOK
 M1 = SCREW LOK
 M3 = SCREW LOK REVERSE FIX

DIM 'A' LENGTH: _____
 0060 = 60mm MIN
 9999 = 9999mm MAX

CONNECTOR 1 FIXING STYLE: _____
 F1 = SCREW LOK
 M1 = SCREW LOK
 M3 = SCREW LOK REVERSE FIX

70 = SILVER-PLATED BRAIDING (SEE NOTE 1)

- NOTES:
 11. POSSIBLE CONFIGURATIONS:
 FEMALE-TO-FEMALE
 MALE-TO-MALE
 MALE-TO-FEMALE
 12. FOR POSSIBLE COMBINATIONS, SEE TABLE 1 ON SHEET 6.
 13. ASSEMBLY G125-FD11670F1-0150F1 IS SHOWN FOR ILLUSTRATIVE PURPOSES. SEE ORDER CODE FOR PART NUMBER.

RTP	1	31.07.24	34508
NAME	ISS.	DATE	CN/CO
APPROVED: A.BOXALL			
CHECKED: A.YEOMANS			
DRAWN: R.PORTLOCK			
ASSEMBLY DRG:			

 www.harwin.com	TOLERANCES X. = ±1mm X.X = ±0.50mm X.XX = ±0.20mm X.XXX = ±0.01mm ANGLES = ±5° UNLESS STATED	THIS DRAWING AND ANY INFORMATION OR DESCRIPTIVE MATTER SET OUT HEREON ARE CONFIDENTIAL AND COPYRIGHT PROPERTY OF THE HARWIN GROUP AND MUST NOT BE DISCLOSED, LOANED, COPIED OR USED FOR MANUFACTURING, TENDERING OR FOR ANY OTHER PURPOSE WITHOUT THEIR WRITTEN PERMISSION.	MATERIAL: SEE SHEET 6	TITLE: G125 DOUBLE ENDED SHIELDED CABLE ASSEMBLIES w/ SILVER-PLATED BRAID
				DRAWING NUMBER: G125-XXXXX70XX-XXXXXX

Customer Information Sheet

IF IN DOUBT - ASK

©

NOT TO SCALE

THIRD ANGLE PROJECTION

ALL DIMENSIONS IN mm

FIXING STYLE IDENTIFICATION

FEMALE

F1

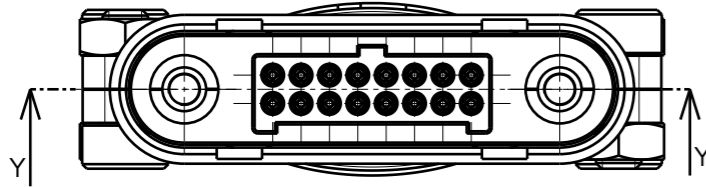

M2 x 0.4 TYP

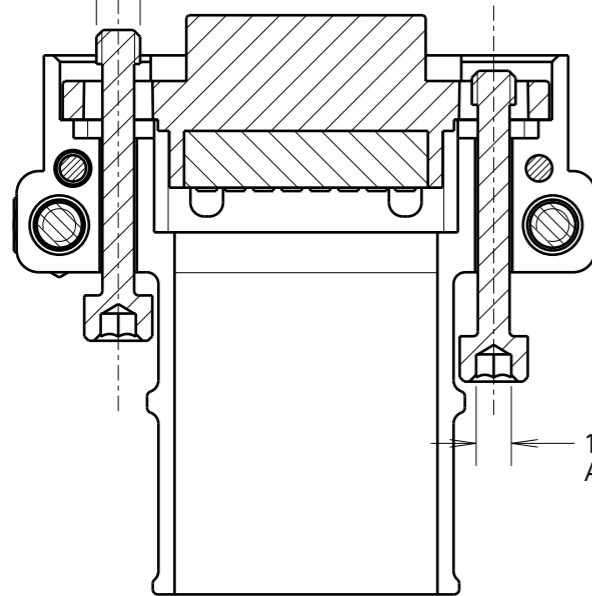

SECTION Y-Y

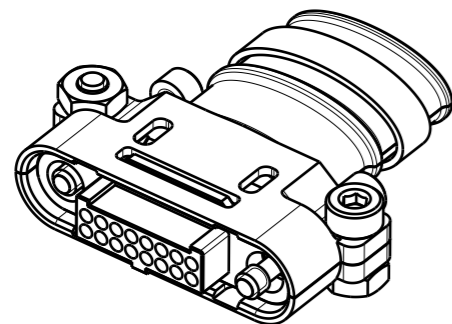

NOTES:
14: SEE BILL OF MATERIALS TABLE ON SHEET 6 AND ORDER CODE FOR FIXING IDENTIFICATION.

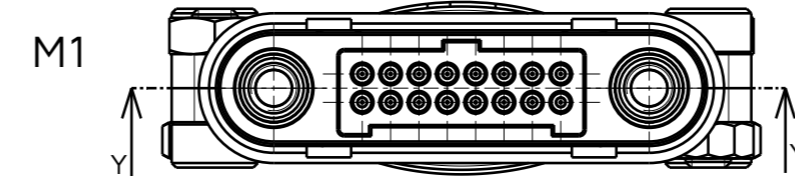

M2 x 0.4 TYP

SECTION Y-Y

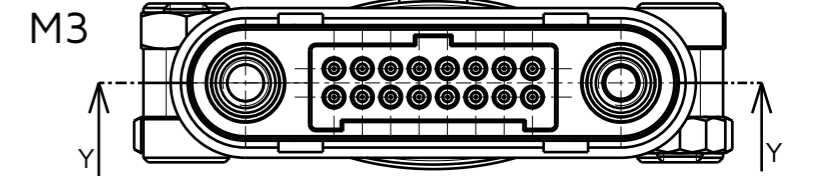
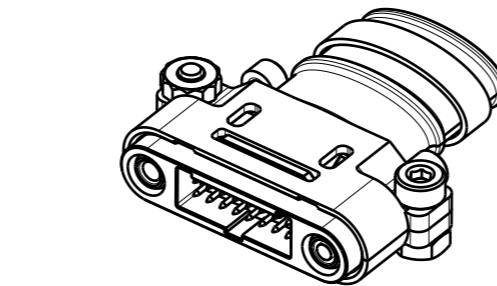

M2 x 0.4 TYP

MALE

SECTION Y-Y

1.5 HEX A/F TYP

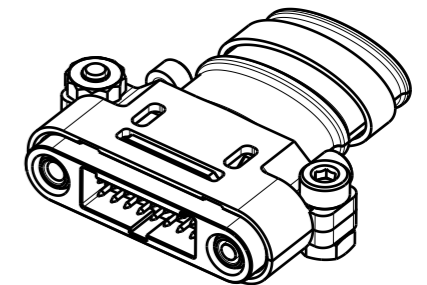

ORDER CODE:

G125-XXXXX70XX-XXXXXX

CONNECTOR 1:

F = FEMALE
M = MALE

WIRING STYLE:

C = STANDARD WIRE
D = TWISTED PAIR

WIRE GAUGE:

1 = 26AWG
2 = 28AWG

TOTAL No. OF CONTACTS:

06, 10, 12, 16,
20, 26, 34, 50

CONNECTOR 2 FIXING STYLE:

F1 = SCREW LOK
M1 = SCREW LOK
M3 = SCREW LOK REVERSE FIX

DIM 'A' LENGTH:

0060 = 60mm MIN
9999 = 9999mm MAX

CONNECTOR 1 FIXING STYLE:

F1 = SCREW LOK
M1 = SCREW LOK
M3 = SCREW LOK REVERSE FIX

70 = SILVER-PLATED BRAIDING (SEE NOTE 1)

RTP	1	31.07.24	34508
NAME	ISS.	DATE	CN/CO
APPROVED: A.BOXALL			
CHECKED: A.YEOMANS			
DRAWN: R.PORTLOCK			
ASSEMBLY DRG:			

HARWIN

www.harwin.com

TOLERANCES
X. = ±1mm
X.X = ±0.50mm
X.XX = ±0.20mm
X.XXX = ±0.01mm
ANGLES = ±5°
UNLESS STATED

THIS DRAWING AND ANY INFORMATION OR DESCRIPTIVE MATTER SET OUT HEREON ARE CONFIDENTIAL AND COPYRIGHT PROPERTY OF THE HARWIN GROUP AND MUST NOT BE DISCLOSED, LOANED, COPIED OR USED FOR MANUFACTURING, TENDERING OR FOR ANY OTHER PURPOSE WITHOUT THEIR WRITTEN PERMISSION.

MATERIAL:
SEE SHEET 6

TITLE: G125 DOUBLE ENDED SHIELDED CABLE ASSEMBLIES w/ SILVER-PLATED BRAID

DRAWING NUMBER:
G125-XXXXX70XX-XXXXXX

SHT 9 OF 9