

Customer Information Sheet

IF IN DOUBT - ASK

©

NOT TO SCALE

THIRD ANGLE PROJECTION

ALL DIMENSIONS IN mm

SPECIFICATIONS:

MATERIAL:

HOUSING = GLASS-FILLED PPS,
UL94V-0, BLACK

CONTACT = PHOSPHOR BRONZE

JACKSCREW = STAINLESS STEEL

FINISH (CONTACTS):

22 = GOLD ON CONTACT AREA,

90/10 TIN/LEAD ON TAILS

42 = GOLD ON CONTACT AREA,

100% TIN OVER NICKEL ON TAILS

05 = GOLD ALL OVER

PACKING:

TUBE

FOR COMPLETE SPECIFICATION, SEE

COMPONENT SPEC. C005XX (LATEST ISSUE)

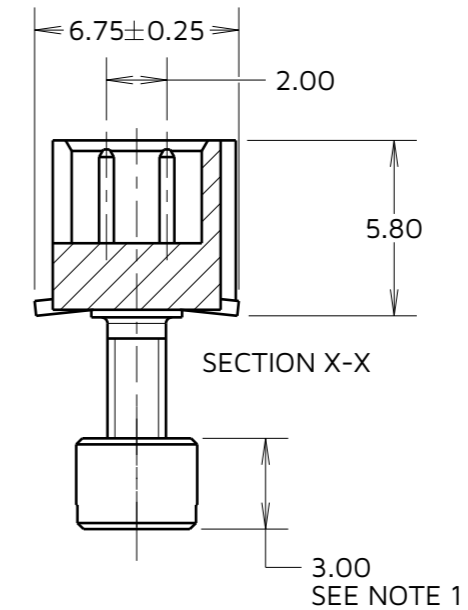
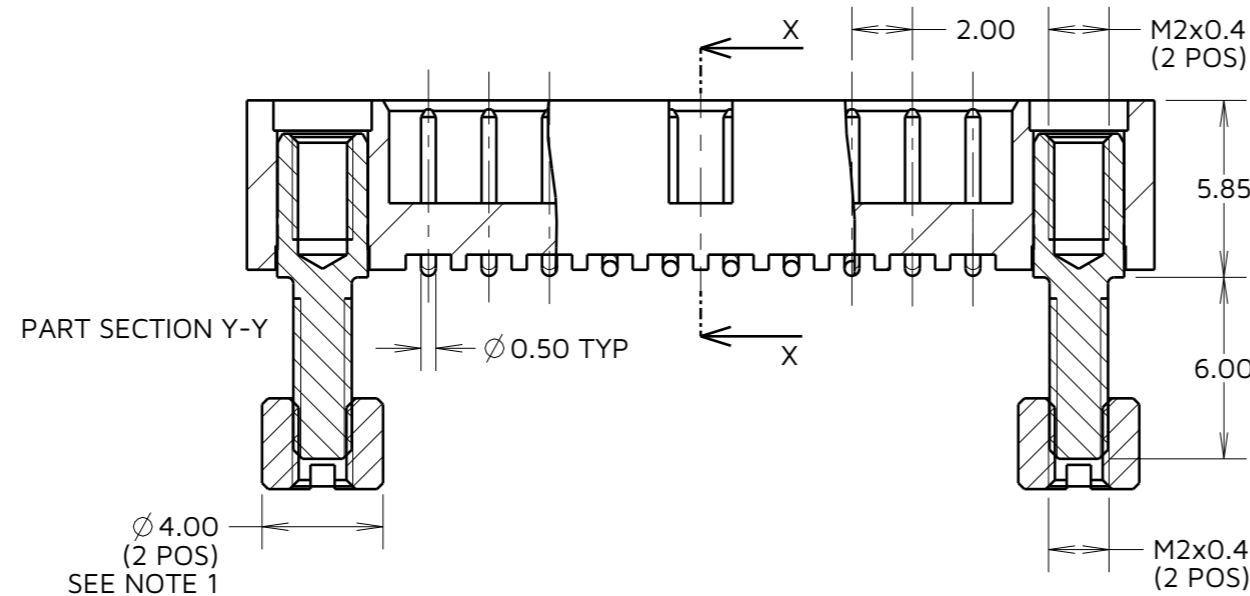
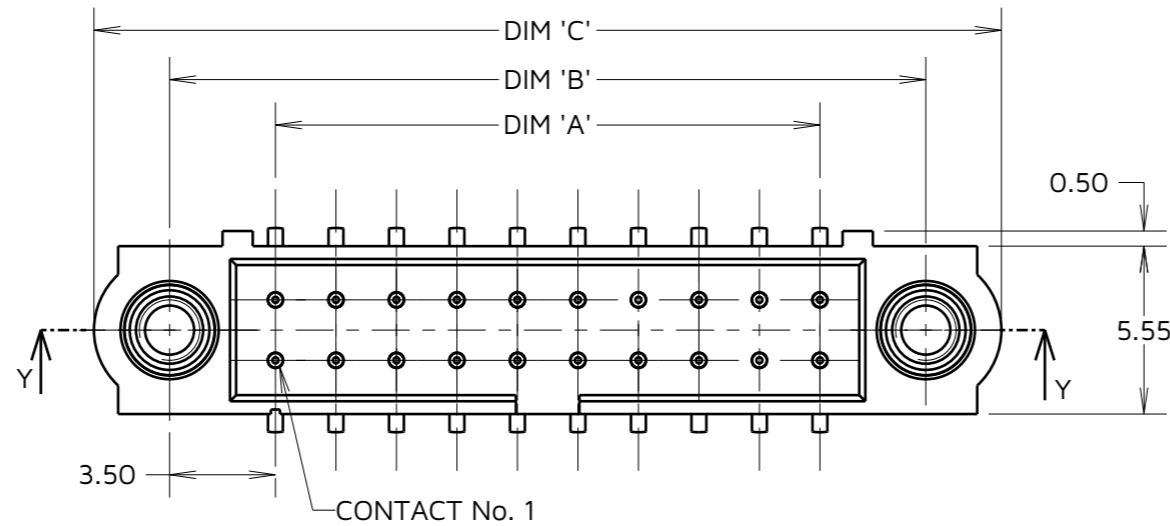
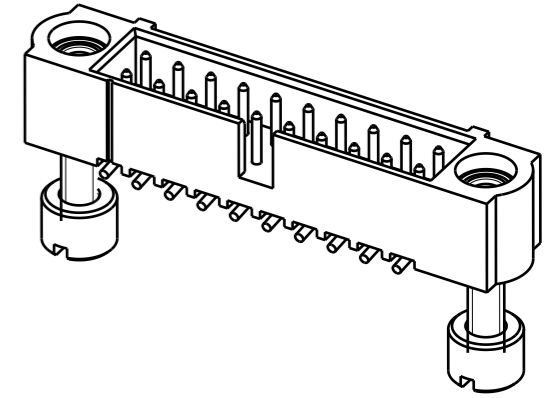

PART No.	WEIGHT (g)
M80-5S104XXMH	1.58
M80-5S106XXMH	1.65
M80-5S108XXMH	1.72
M80-5S110XXMH	1.79
M80-5S112XXMH	1.85
M80-5S114XXMH	1.92
M80-5S116XXMH	1.99
M80-5S118XXMH	2.06
M80-5S120XXMH	2.13
M80-5S122XXMH	2.19
M80-5S124XXMH	2.26
M80-5S126XXMH	2.33
M80-5S128XXMH	2.40
M80-5S130XXMH	2.47
M80-5S132XXMH	2.53
M80-5S134XXMH	2.60
M80-5S136XXMH	2.67
M80-5S138XXMH	2.74
M80-5S140XXMH	2.81
M80-5S142XXMH	2.87
M80-5S144XXMH	2.94
M80-5S146XXMH	3.01
M80-5S148XXMH	3.08
M80-5S150XXMH	3.15

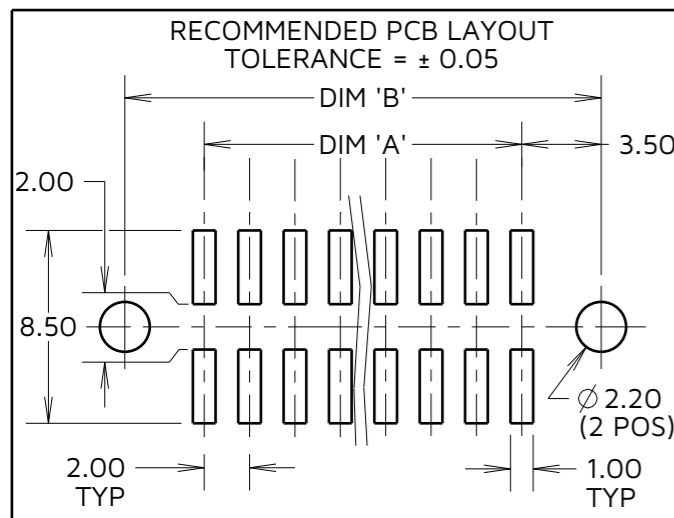

DIMENSION	CALCULATION
DIM 'A'	TOTAL No. OF CONTACTS - 2.00
DIM 'B'	TOTAL No. OF CONTACTS + 5.00
DIM 'C'	TOTAL No. OF CONTACTS + 10.0

EXAMPLE: CONNECTOR WITH 20 CONTACTS, GOLD ON CONTACT AREA AND 100% TIN ON TAIL, M80-5s12042MH.

DIM 'A' = 18.00mm, DIM 'B' = 25.00mm, DIM 'C' = 30.0mm

ORDER CODE:
M80-5S1XXXXMH

TOTAL No. OF CONTACTS
 04 TO 50
 (EVEN NUMBERS ONLY)

FINISH
 22 - GOLD ON CONTACT AREA / TIN/LEAD ON TAIL
 42 - GOLD ON CONTACT AREA / 100% TIN ON TAIL
 05 - ALL OVER GOLD

MJ	2	11.12.24	35293
NAME	ISS.	DATE	CN/CO
APPROVED:	M. JELLEY		
CHECKED:	R. ALEXANDER		
DRAWN:	M G PLESTED		

NOTES:

- CONNECTOR IS SUPPLIED WITH BOARD MOUNT NUTS BUT NOT ASSEMBLED AS SHOWN FOR ILLUSTRATION.
- M80-5S1XXXXMH IS SHOWN FOR ILLUSTRATION PURPOSES, SEE ORDER CODE FOR VARIANTS

HARWIN

www.harwin.com

TOLERANCES
 X. = ±1mm
 X.X = ±0.50mm
 X.XX = ±0.20mm
 X.XXX = ±0.01mm
 ANGLES = ±5°
 UNLESS STATED

THIS DRAWING AND ANY INFORMATION OR DESCRIPTIVE MATTER SET OUT HEREON ARE CONFIDENTIAL AND COPYRIGHT PROPERTY OF THE HARWIN GROUP AND MUST NOT BE DISCLOSED, LOANED, COPIED OR USED FOR MANUFACTURING, TENDERING OR FOR ANY OTHER PURPOSE WITHOUT THEIR WRITTEN PERMISSION.

MATERIAL & FINISH:
 SEE ABOVE

TITLE: DATAMATE J-TEK MALE VERTICAL SMT CONNECTOR ASSEMBLY

DRAWING NUMBER: M80-5S1XXXXMH