

Customer Information Sheet

DRAWING No.: M80-4DI0205FI-00-000-04-327	IF IN DOUBT - ASK	©	NOT TO SCALE	THIRD ANGLE PROJECTION	ALL DIMENSIONS IN mm
------------------------------------------	-------------------	---	--------------	------------------------	----------------------

SPECIFICATIONS:

**MATERIAL:**  
HOUSING: GLASS FILLED PPS, UL94V-0, BLACK  
SIGNAL CONTACT:  
CLIP = BERYLIUM COPPER  
SHELL = BRASS  
POWER CONTACT:  
BODY = COPPER ALLOY  
LATCHING COLLAR = BERYLLIUM COPPER  
JACKSCREW, CIRCLIP: STAINLESS STEEL

**FINISH:**  
SIGNAL CONTACT:  
CLIP = 0.3µm GOLD  
SHELL = 0.25-0.3µm GOLD  
POWER CONTACT:  
BODY = GOLD  
LATCHING COLLAR = NICKEL

**ELECTRICAL:**  
WORKING VOLTAGE = 120V AC/DC  
VOLTAGE PROOF = 360V AC/DC  
INSULATION RESISTANCE = 100MΩ MIN  
SIGNAL CONTACT:  
CURRENT RATING AT 25°C = 3.0A MAX  
CURRENT RATING AT 85°C = 2.2A MAX  
CONTACT RESISTANCE = 25 mΩ MAX  
POWER CONTACT:  
CONTACT RESISTANCE = 6 mΩ MAX  
CURRENT RATING = 10A MAX WITH 16AWG  
CONTACT AS SPECIFIED

**MECHANICAL:**  
DURABILITY = 500 OPERATIONS  
SIGNAL CONTACT:  
INSERTION FORCE = 2.8N MAX  
WITHDRAWAL FORCE = 0.2N MIN  
POWER CONTACT:  
INSERTION FORCE = 5N MAX  
WITHDRAWAL FORCE = 0.5N MIN

**ENVIRONMENTAL:**  
TEMPERATURE RANGE = -55°C TO +125°C

**PACKING:**  
BAG  
FOR COMPLETE SPECIFICATION SEE COMPONENT SPECIFICATION C005XX (LATEST ISSUE)

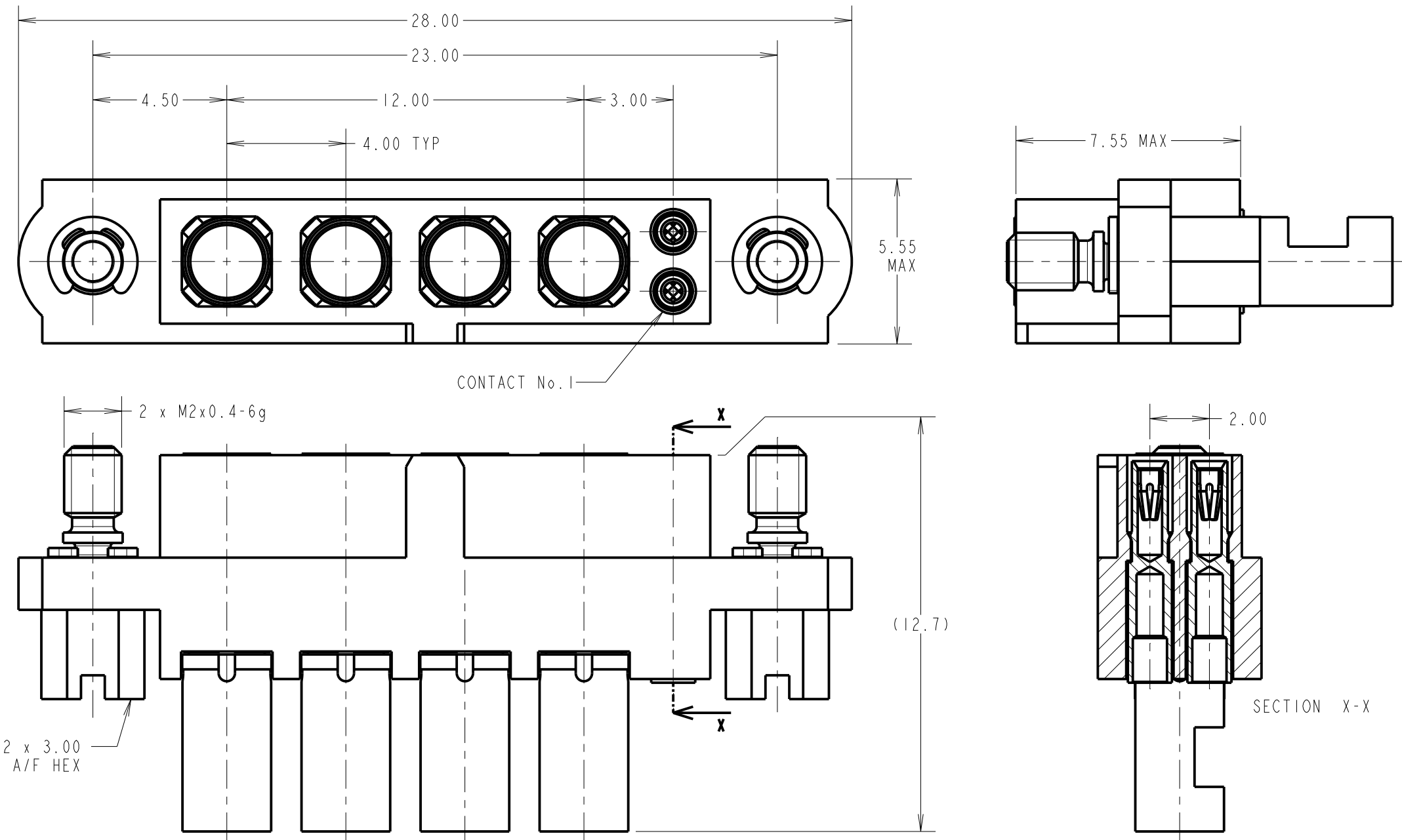

- NOTES:
- 1. CONNECTORS ARE SUPPLIED WITH CONTACTS LOOSE.
  - 2. FOR EXTRA SIGNAL CONTACTS, USE PART NUMBER M80-0110005.
  - 3. RECOMMENDED SIGNAL WIRE TYPE = BS 3G 210 TYPE A, PTFE INSULATED 22 AWG. MAX INSULATION DIAMETER = Ø1.10mm. STRIP WIRE BY 2.00MM FOR CRIMPING.
  - 4. RECOMMENDED HAND CRIMP TOOL FOR SIGNAL CONTACTS = M22520/2-01 WITH POSITIONER T5747.
  - 5. SIGNAL CONTACT INSERTION AND EXTRACTION TOOL = Z80-280.
  - 6. FOR EXTRA POWER CONTACTS, USE PART NUMBER M80-327
  - 7. POWER CONTACT WIRE, STRIP BY 5.00mm MINIMUM
  - 8. POWER CONTACT EXTRACTION TOOL = Z80-290
  - 9. INSTRUCTION SHEETS ARE AVAILABLE.

RA	I	21.12.10	-----
NAME	ISS.	DATE	CN/CO
APPROVED:		R. ADDE	
CHECKED:		M.G. PLESTED	
DRAWN:		R. ADDE	
CUSTOMER REF. :			
ASSEMBLY DRG:			

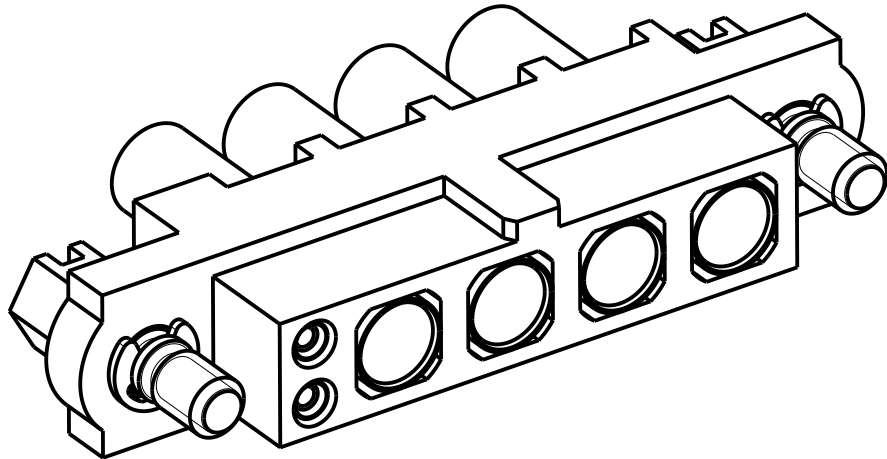



www.harwin.com  
technical@harwin.com

THIS DRAWING AND ANY INFORMATION OR DESCRIPTIVE MATTER SET OUT HEREON ARE CONFIDENTIAL AND COPYRIGHT PROPERTY OF THE HARWIN GROUP AND MUST NOT BE DISCLOSED, LOANED, COPIED OR USED FOR MANUFACTURING, TENDERING OR FOR ANY OTHER PURPOSE WITHOUT THEIR WRITTEN PERMISSION.

TOLERANCES
X. = ±1mm
X.X = ±0.50mm
X.XX = ±0.20mm
X.XXX = ±0.01mm
ANGLES = ±5°
UNLESS STATED

MATERIAL:	SEE ABOVE
FINISH:	SEE ABOVE
S/AREA:	mm <sup>2</sup>

TITLE:	JACKSCREW DATAMATE MIXED TECHNOLOGY CRIMP FEMALE ASSEMBLY
DRAWING NUMBER:	M80-4DI0205FI-00-000-04-327
SHT	2 OF 2