

Customer Information Sheet

IF IN DOUBT - ASK

©

NOT TO SCALE

THIRD ANGLE PROJECTION

ALL DIMENSIONS IN mm

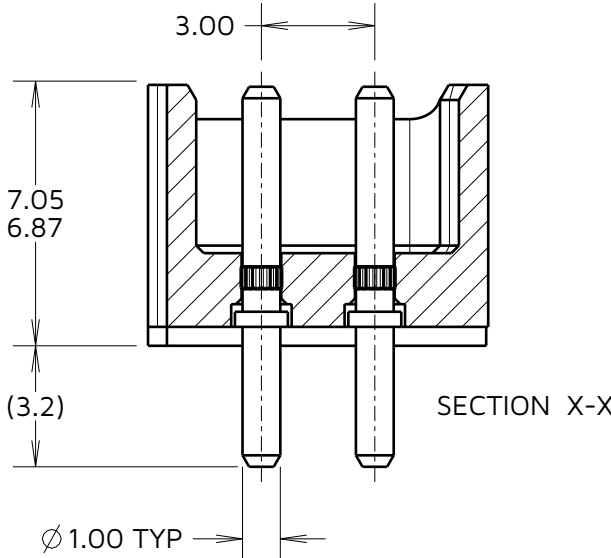
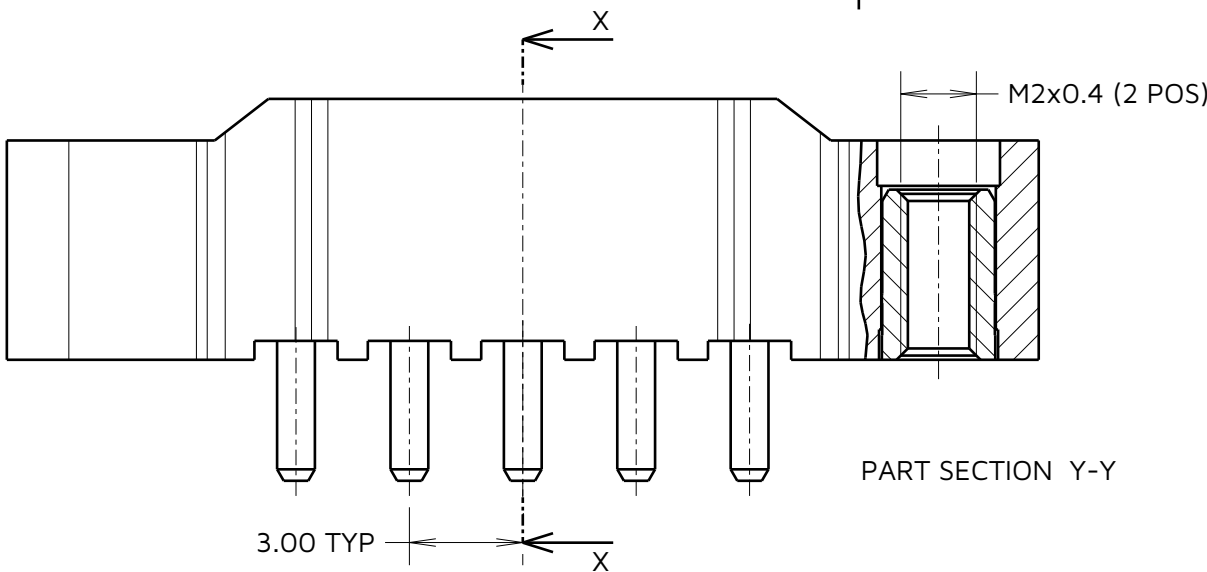
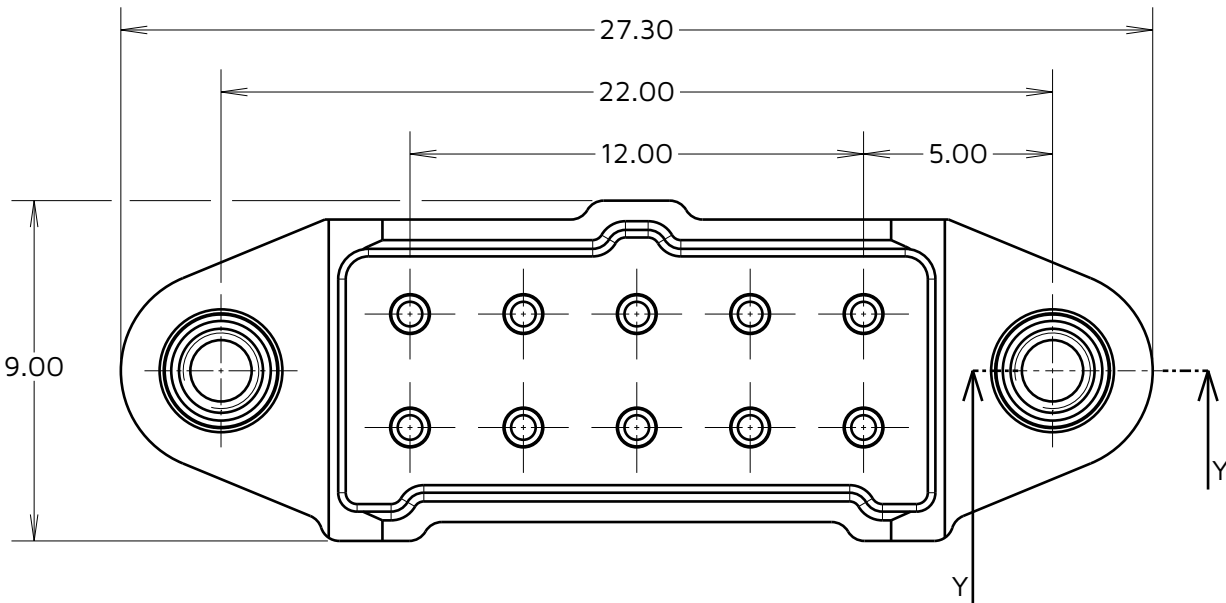

SPECIFICATONS:
MATERIAL:
HOUSING = GLASS-FILLED PA46 UL94V-0, GREEN
CONTACTS = BRASS
JACKSCREW NUT = STAINLESS STEEL
FINISH:
GOLD
PACKING:
TUBE
FOR COMPLETE SPECIFICATION, SEE COMPONENT
SPECIFICIATION C048XX (LATEST ISSUE)

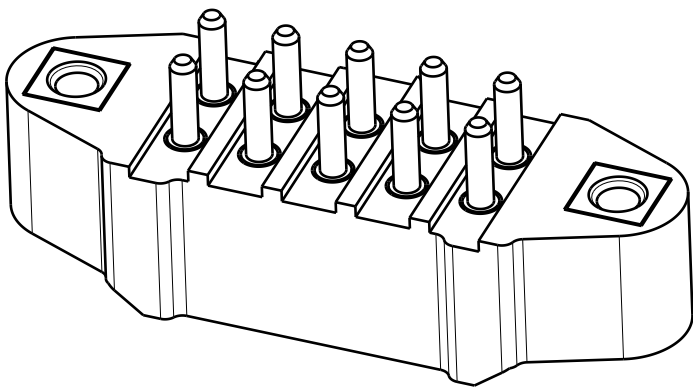
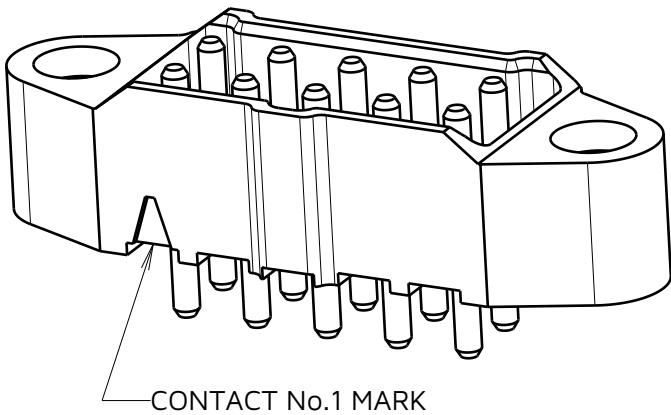

RECOMMENDED PCB LAYOUT
(ALL TOLERANCES $\pm 0.05\text{mm}$)

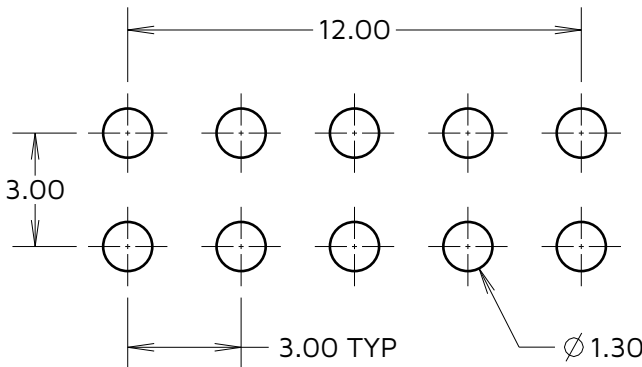

HARWIN

www.harwin.com

TOLERANCES
X. = $\pm 1\text{mm}$
X.X = $\pm 0.50\text{mm}$
X.XX = $\pm 0.20\text{mm}$
X.XXX = $\pm 0.01\text{mm}$
ANGLES = $\pm 5^\circ$
UNLESS STATED

THIS DRAWING AND ANY
INFORMATION OR DESCRIPTIVE
MATTER SET OUT HEREON ARE
CONFIDENTIAL AND COPYRIGHT
PROPERTY OF THE HARWIN GROUP
AND MUST NOT BE DISCLOSED,
LOANED, COPIED OR USED FOR
MANUFACTURING, TENDERING OR FOR
ANY OTHER PURPOSE WITHOUT THEIR
WRITTEN PERMISSION.

MATERIAL & FINISH:

SEE ABOVE

TITLE: 1mm POWER CONNECTOR
DIL VERTICAL PC TAIL
MALE ASSEMBLY

DRAWING NUMBER:
M300-MV31045M1

SHT
2
OF
2

RTP	2	05.12.24	35312
NAME	ISS.	DATE	CN/CO
APPROVED: R.PORTLOCK			
CHECKED: A.BOXALL			
DRAWN: MARK G PLESTED			